



SPARE PARTS FOR AGRICULTURAL IMPLEMENTS



MADE IN ITALY



SPARE PARTS FOR AGRICULTURAL IMPLEMENTS

 **MADE IN ITALY**

GLI ANNI '50 THE '50S

Durante il secondo dopo guerra, in un territorio che voleva rinascere, la famiglia Favero si rimbocca le maniche e risponde alle esigenze del tempo lavorando piccoli attrezzi di metallo. Ad una crescente domanda di lavoro, le due piccole officine Favero uniscono le forze nei primi anni '50 creando un'unica realtà dotata di macchinari azionati ad energia idraulica. La produzione al tempo consisteva in punte di ferro per scalpelli e picconi, lame per vanghe e altri semplici attrezzi da lavoro.

During the second post-World War period, in a territory that wanted to reborn, the Favero family rolls up their sleeves and responds to the needs of the time working on small metal tools. To an increasing demand for work, the two Favero workshops join forces in the early 1950s, creating a single reality equipped with hydraulically powered machinery. Production at the time consisted of iron tips for chisels and pickaxes, spade blades and other simple work tools.

1954

La passione per il lavoro porta la famiglia Favero a crescere, da laboratorio a conduzione familiare diviene ben presto una piccola società chiamata "Officine Riunite Favero Sas" (1954), ampliando l'offerta dei prodotti con l'attrezzatura da giardinaggio.

The passion for work leads the Favero family to grow, from a family-run workshop it soon became a small company called "Officine Riunite Favero Sas" (1954), expanding the products offering with gardening equipment.



**passione
per il lavoro
passion
for work**



1964

Durante gli anni '60 l'azienda si trasferisce nella sede attuale sviluppando una nuova gamma di prodotti per l'agricoltura e di ricambi per macchine agricole. Nasce nel 1964 l'attuale società O.F.A.S. S.p.a. (Officine Favero Attrezzi Stampati).

Rispondere in modo attento ed efficiente alle richieste del mercato nazionale ed internazionale ha portato la società a crescere e migliorare giorno dopo giorno, diventando leader nel settore. L'attenzione alla tradizione e la volontà d'innovazione hanno caratterizzato O.F.A.S. nel corso degli anni, sempre affiancate dall'impegno a garantire la migliore qualità del prodotto.

During the 60s the company moved to the present site developing a new range of products for farming and of spare parts for agricultural machinery. In 1964 born the today's company O.F.A.S. S.p.a. (Officine Favero Attrezzi Stampati).

Reply with attention and efficiency to the demands of the national and international market led the company to grow and improve day by day, becoming a leader in the industry. The attention to tradition and the desire for innovation have characterized O.F.A.S. during the years, always supported by the commitment to guaranteeing the best product quality.

Crescere e migliorare Grow and improve





2013

La passione ha portato la società ad ampliare la propria offerta spaziando nei materiali: oltre alla lavorazione dei metalli, nel 2013 è stata sviluppata la tecnologia di vulcanizzazione mescole in gomma, al fine di produrre internamente gli pneumatici delle ruote da seminatrice.

Passion has led the company to expand its own offer ranging across materials: in addition to metalworking, in 2013 the rubber compound vulcanization technology has been developed, with the aim to produce the tires for the seeder wheels internally.



non solo acciaio not only steel

Il processo di vulcanizzazione delle mescole in gomma ha innalzato il livello qualitativo del prodotto, portando la specializzazione Agricola una scelta d'opzione migliore anche in abbinamento alla tipologia del terreno in lavorazione, su scala mondiale. Successivamente, O.F.A.S. ha inserito l'ultimo tassello al completamento del ciclo produttivo, proponendo nella sua gamma prodotti i Cuscinetti Volventi (Ruote Seminatrici) e i supporti HUB (Dischi per *Tillage*).

The rubber compounds vulcanization process increased quality level of the product, bringing the Agricultural specialization a better option choice also combined to the type of soil being worked, on a worldwide scale. Afterwards, O.F.A.S. has inserted the last piece to complete the production cycle, offering in its product range Rolling Bearings (Seeder Wheels) and HUB supports (Tillage Discs).



OLTRE I CONFINI BEYOND BORDERS

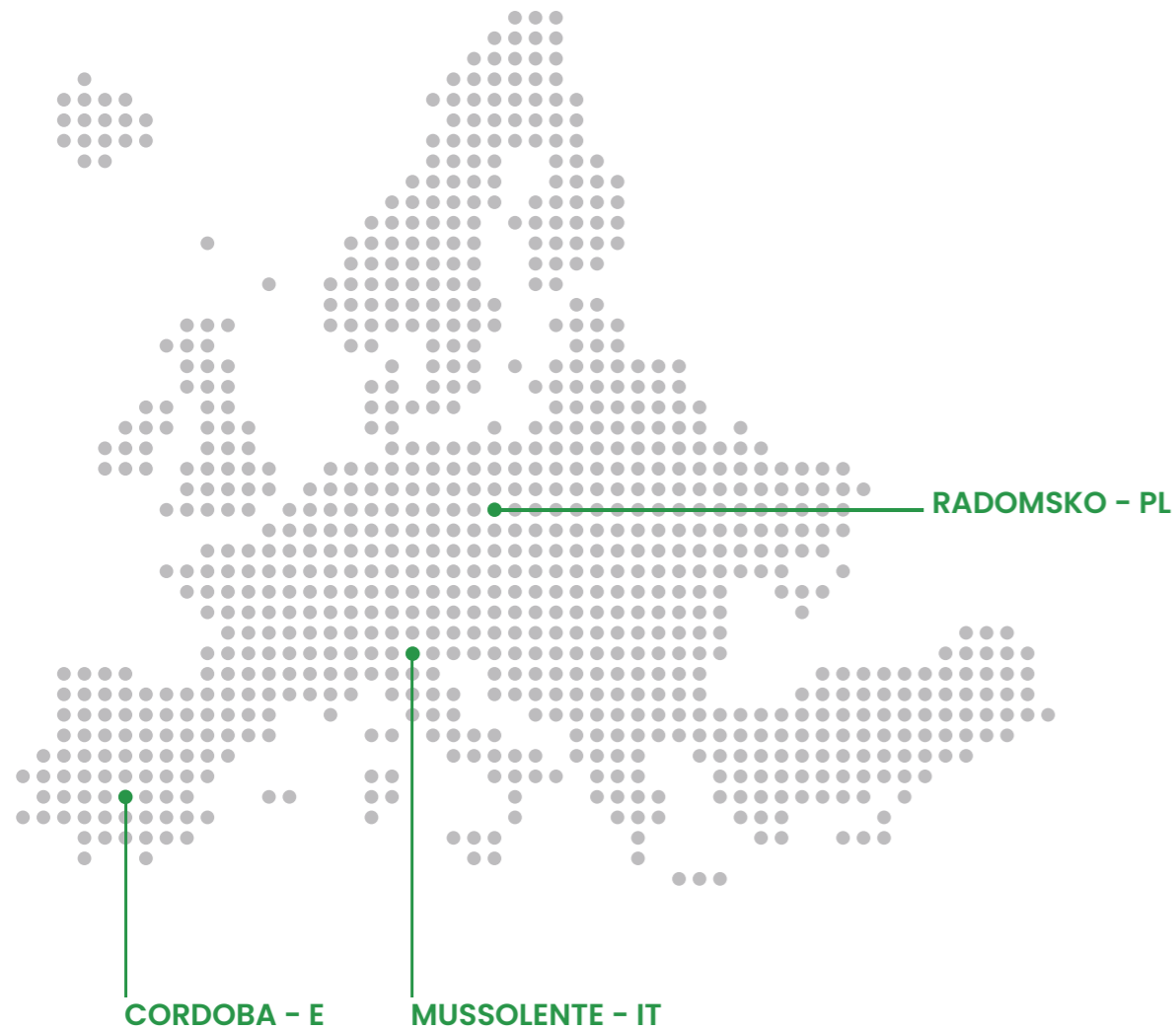

Già forte nell'esperienza di una partecipazione in Spagna, iniziata nel 2012, nel 2017 O.F.A.S. espande i suoi confini. La sua passione per il lavoro viene portata in un nuovo stabilimento produttivo in Polonia, in risposta ad una sempre crescente domanda del mercato.

Already strong from the experience of a participation in Spain, which began in 2012, in 2017 O.F.A.S. expands again its borders. The passion for work is brought in a new production plant in Poland, in response to an ever-increasing market demand.

OGGI TODAY

Da sempre in O.F.A.S. storia e tecnica si fondono per creare un prodotto prestante di alta qualità e resistenza, senza rinunciare alla ricerca volta all'ottimizzazione della proposta e alla novità, con la possibilità di studiare nuovi prodotti ad alto livello di personalizzazione. Il nuovo passaggio generazionale in corso porta in O.F.A.S. nuovi obiettivi, dalla riscoperta delle sue radici all'esigenza di un nuovo impegno ambientale e sociale per il territorio che abita.

Since ever in O.F.A.S. history and technique merge to create a performing product of high quality and resistance, without giving up the research for an optimization of the proposal and for the new, with the chance to study new products with a high level of customization. The new generational transition in progress brings O.F.A.S. new goals, from the rediscovery of its roots to the need for a new environmental and social commitment for the territory it inhabits.

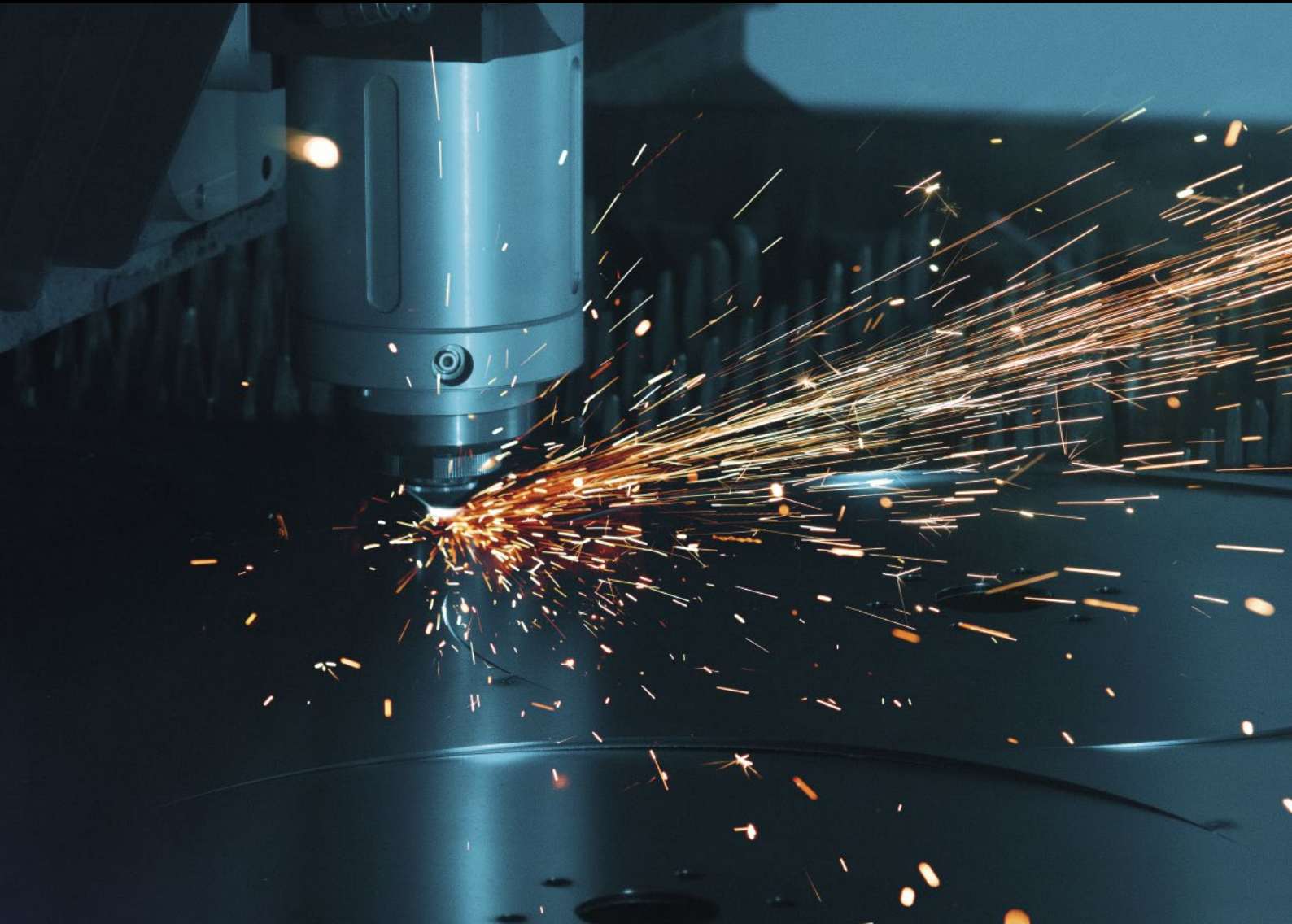

**storia e tecnica si fondono
history and technique merge**

La qualità in O.F.A.S. The quality in O.F.A.S.

Nel garantire un prodotto di qualità, O.F.A.S. parte dalla ricerca e selezione delle **migliori materie prime**: l'acciaio proviene dalle migliori acciaierie d'Europa, selezionate nel corso degli anni, e la gomma viene puntualmente rifornita e attentamente conservata, per garantire le caratteristiche tecniche del materiale durante la lavorazione.

To ensure a quality product, O.F.A.S. starts from the research and selection of the **best raw materials**: the steel comes from the best steel mills in Europe, selected during the years, and the rubber is promptly replenished and carefully preserved, to guarantee the technical characteristics of the material during manufacturing.



La **CONOSCENZA** e i **CONTROLLI** sulla materia prima, in particolare acciaio ad alta qualità, permettono ad O.F.A.S. di lavorare con tecniche consolidate volte ad enfatizzare le caratteristiche chimico-fisiche del materiale e a massimizzare le prestazioni del prodotto. Il caratteristico trattamento termico applicato dona al prodotto finale un'elevata resistenza meccanica e all'usura mantenendo contenuti i costi di produzione.

La **PROGETTAZIONE** del prodotto considera sia le caratteristiche della materia prima che l'utilizzo finale, un'attenzione che nel processo produttivo si traduce in puntuali **CONTROLLI QUALITATIVI** e nella **TRACCIABILITÀ** del prodotto, fin dall'origine.

La qualità del prodotto creato, in base alla sua tipologia, viene testata tramite l'ausilio di appositi banchi prova, con ulteriore e definitivo step di validazione in campo aperto. Il Test in Campo aperto, con ausilio di Trattorie Agricola e macchinario dedicato (su cui vengono assemblati i prodotti O.F.A.S.), garantisce la piena funzionalità, che verrà altresì riscontrata dal cliente finale.

The **KNOWLEDGE** and the **CONTROLS** on the raw material, in particular of a high-quality steel, allow O.F.A.S. to work with consolidated techniques aimed at emphasize the chemical-physical characteristics of the material and at maximizing product performance. The characteristic heat treatment applied gives the final product high mechanical and usury resistance keeping production costs low.

Product **DESIGN** considers both the characteristics of the raw material and the end use, an attention that translates into timely **QUALITY CONTROLS** in the production process and product **TRACEABILITY**, since the origin.

The quality of the product created, based on its type, is tested with the aid of special test benches, with a further and definitive validation step in the open field. The open field test, with the aid of an Agricultural Tractor and a dedicated machinery (on which O.F.A.S. products are assembled), guarantees full functionality, which will also be verified by the end-user.



Monitoraggio Monitoring

Durante la produzione, il nostro personale monitora i passaggi e il costante rispetto delle caratteristiche del prodotto, così come definite nella progettazione e successivamente validate.

During manufacturing, our staff monitors the steps and the constant respect for the product characteristics, as defined during the design phase and later validated.

Tracciabilità e controllo Tracking and control

Controlli e tracciabilità permettono la risoluzione di eventuali criticità del prodotto, verificando se è un difetto o se il problema riscontrato è dovuto ad un impiego scorretto.

Controls and traceability allow the resolution of any critical issues of the product, checking whether it is a defect or whether the problem encountered is due to an incorrect use.

La volontà di massimizzare la resa dei prodotti offerti porta O.F.A.S. ad un costante studio e miglioramento, oltre che ad ampliare la sua proposta integrando i prodotti storici con nuovi, tra i quali i sistemi integrati, per aumentare l'efficienza in campo.

La solidità del sistema qualitativo su cui si basa O.F.A.S. viene costantemente verificato e certificato dai vari enti preposti tramite certificazioni e visite ispettive, in modo da rendere sempre più efficienti ed evoluti i processi produttivi.

The willingness to maximize the yield of the products offered leads O.F.A.S. to a constant study and improvement, as well as expanding its proposal integrating historical products with new ones, among which the integrated systems, to increase efficiency on the field.

The solidity of the quality system on which O.F.A.S. is based, is constantly verified and certified by the various bodies in charge through certifications and inspections, in order to make the production processes increasingly efficient and advanced.

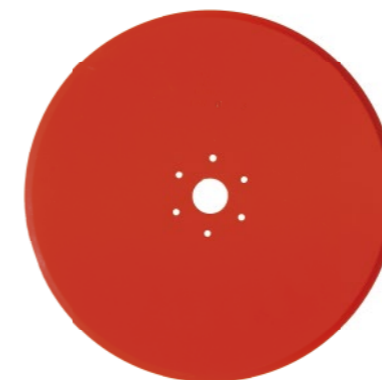

O.F.A.S. è sempre pronta a nuovi progetti e allo studio di particolari personalizzazioni del prodotto per garantire la maggior soddisfazione dei suoi clienti.

O.F.A.S. is always ready for new projects and for studying particular product customizations to ensure the greatest satisfaction of its customers.

Che sia una scelta stilistica, o una necessità tecnica, i nostri tecnici si impegnano per produrre quanto richiesto con la dovuta attenzione e dedizione.

Whether a stylistic choice, or a technical need, our technicians are committed to producing what is requested with due attention and dedication.



Index Indice

**DISCS FOR HARROWS
DISCHI PER ERPICI**

17

**DISCS FOR SEEDERS
DISCHI PER SEMINATRICI**

33

**RAPID TILLAGE
LAVORAZIONE RAPIDA**

43

**AGRI HUB FOR RAPID TILLAGE
AGRI HUB PER RAPID TILLAGE**

47

**SUBSOILER BLADES
LAME PER RIPUNTATORE**

59

**SPRING TINES AND SWEEPS
MOLLE E VOMERI A LANCIA**

65

**KNIVES FOR FEED MIXERS
COLTELLI PER CARRI MISCELATORI**

81

**COSTUM PLOUGHS PARTS
COMPONENTI PERSONALIZZATI PER ARATRI**

93

INDICAZIONI ALLA LETTURA

96

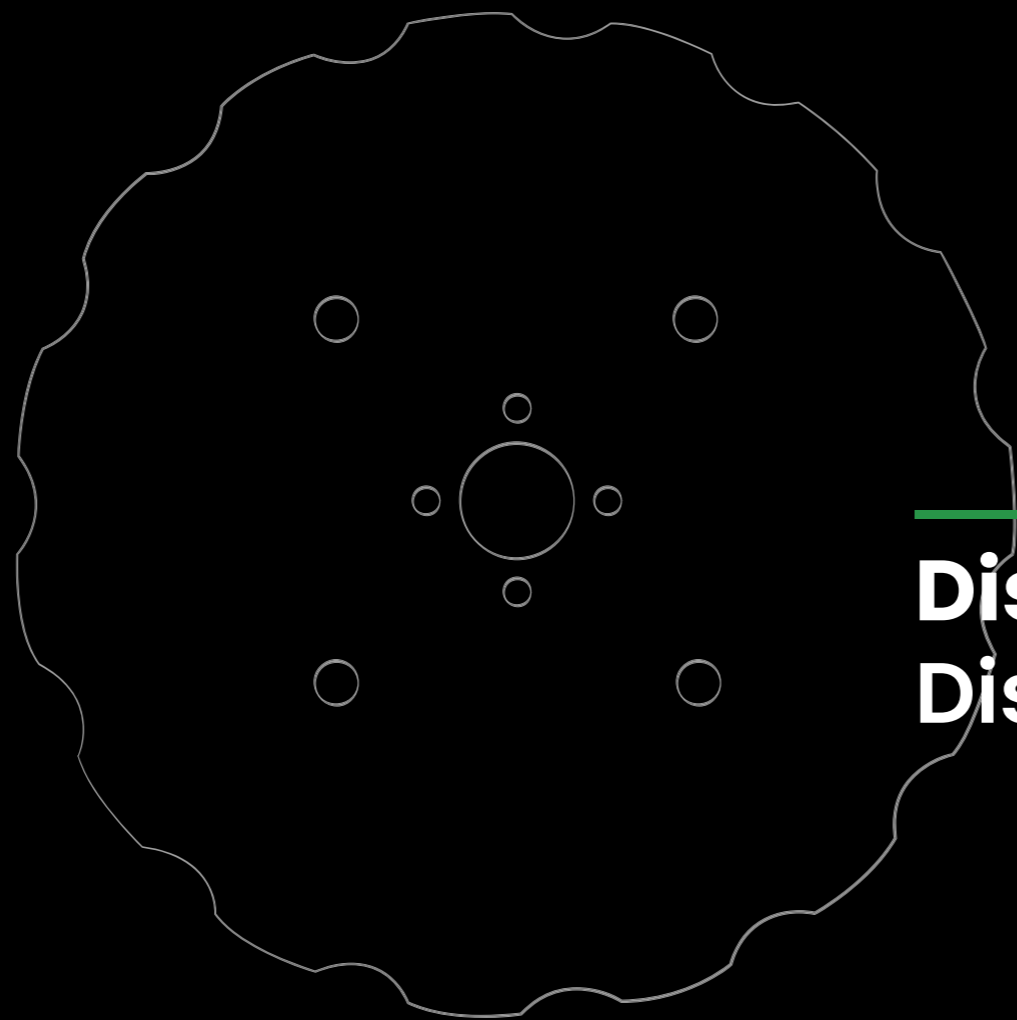

Discs for harrows
Dischi per erpici

CONCAVE DISCS WITH FLAT CENTER (FOR MOULD)
DISCHI CONCAVI CON CENTRO PIANO (PER STAMPO)

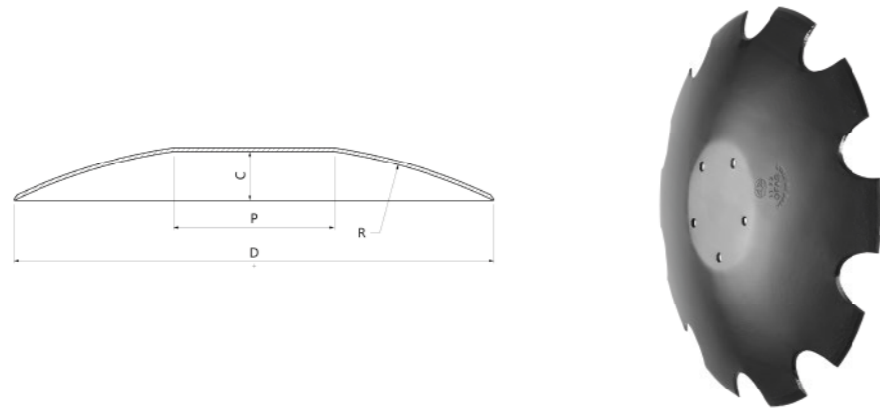

DIAMETER D		MOULD COD. 009		MOULD COD. 026		MOULD COD. 008		MOULD COD. 033		MOULD COD. 035	
		P	R	P	R	P	R	P	R	P	R
mm	in	mm	in	mm	in	mm	in	mm	in	mm	in
250	10"	11,5	29/64	-	-	-	-	-	-	-	-
280	11"	15	19/32	-	-	-	-	-	-	-	-
305	12"	18,5	47/64	-	-	-	-	-	-	-	-
310	12"	19	3/4	-	-	-	-	-	-	-	-
325	12,5"	21,5	27/32	-	-	-	-	-	-	-	-
330	13"	22	55/64	19	3/4	18,5	47/64	17,5	11/16	-	-
350	13,5"	25	63/64	22	55/64	21,5	27/32	20,5	13/16	-	-
360	14"	27	1" 1/16	23,5	59/64	23	29/32	22	55/64	-	-
410	16"	36	1" 27/64	31,5	1" 15/64	32	1" 17/64	31	1" 7/32	-	-
460	18"	46	1" 13/16	41	1" 39/64	42	1" 21/32	41	1" 39/64	30	1" 3/16
510	20"	58	2" 9/32	52	2" 3/64	53	2" 3/32	52	2" 3/64	38,5	1" 33/64
530	21"	-	-	57	2" 1/4	58	2" 9/32	57	2" 1/4	42	1" 21/32
560	22"	-	-	64	2" 33/64	66	2" 19/32	65	2" 9/16	47,5	1" 7/8
610	24"	-	-	78	3" 5/64	80,5	3" 11/64	79,5	3" 1/8	58,5	2" 19/64
660	26"	-	-	-	-	97	3" 13/16	96	3" 25/32	69	2" 23/32
710	28"	-	-	-	-	114	4" 31/64	113	4" 29/64	-	-
760	30"	-	-	-	-	-	-	-	-	-	-

DIAMETER D		MOULD COD. 045		MOULD COD. 052		MOULD COD. 083		MOULD COD. 085		MOULD COD. 075-1	
		P	R	P	R	P	R	P	R	P	R
mm	in	mm	in	mm	in	mm	in	mm	in	mm	in
250	10"	-	-	-	-	-	-	-	-	-	-
280	11"	-	-	-	-	-	-	-	-	-	-
305	12"	-	-	-	-	-	-	-	-	-	-
310	12"	20	25/32	-	-	-	-	-	-	-	-
325	12,5"	22,5	57/64	-	-	-	-	-	-	-	-
330	13"	23	29/32	-	-	-	-	-	-	-	-
350	13,5"	27	1" 1/16	20	25/32	-	-	-	-	-	-
360	14"	29	1" 9/64	21,5	27/32	-	-	-	-	-	-
410	16"	39	1" 17/32	30	1" 3/16	24	15/16	-	-	28,5	1" 1/8
460	18"	51	2" 1/64	39,5	1" 9/16	32	1" 17/64	-	-	37,5	1" 15/32
510	20"	64,5	2" 35/64	50	1" 31/32	41	1" 39/64	-	-	47,5	1" 7/8
530	21"	70,5	2" 25/32	54,5	2" 9/64	45	1" 49/64	-	-	52	2" 3/64
560	22"	78	3" 5/64	61,5	2" 27/64	51	2" 1/64	-	-	59	2" 21/64
610	24"	-	-	-	-	62	2" 7/16	33	1" 19/64	71,5	2" 13/16
660	26"	-	-	-	-	74	2" 29/32	40,5	1" 19/32	86	3" 25/64
710	28"	-	-	-	-	87	3" 27/64	49	1" 59/64	101,5	4"
760	30"	-	-	-	-	-	-	-	-	118	4" 41/64

BULLDOG DISC
DISCO BULLDOG

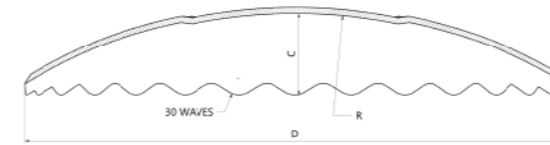

DIAMETER D		Mould Cod. 073	
		P	R
mm	in	mm	in
560	22"	49	1" 59/64
610	24"	61	2" 13/32
660	26"	74	2" 29/32
710	28"	89	3" 1/2



The model can also be offered in a flat version (ref. Mould cod. 073-1).

Il modello può anche essere proposto in versione piana (rif. Mould cod. 073-1).

AGGRESSIVE DISC
DISCO AGGRESSIVO

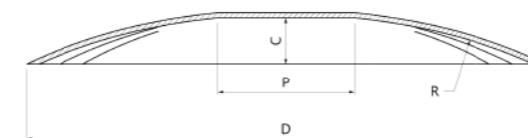

DIAMETER D		Mould Cod. 124	
		P	R
mm	in	mm	in
510	20"	45	1" 49/64
560	22"	57	2" 1/4



PUNCHED CONCAVE DISC
DISCO CONCAVO PUNZONATO

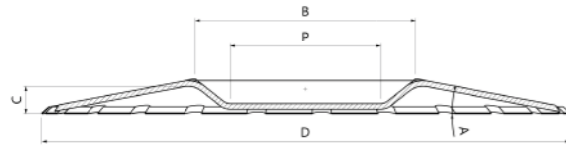

DIAMETER D		Mould Cod. 046	
		P	160
B	234	9" 7/32	
A	10,7°		
		C	
mm	in	mm	in
410	16"	14,5	37/64
460	18"	19,5	49/64
510	20"	24	15/16
560	22"	29	1" 9/64

PUNCHED CONCAVE DISCS
DISCHI CONCAVI PUNZONATI

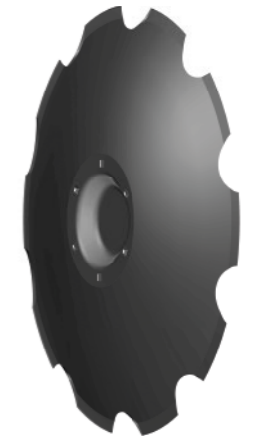
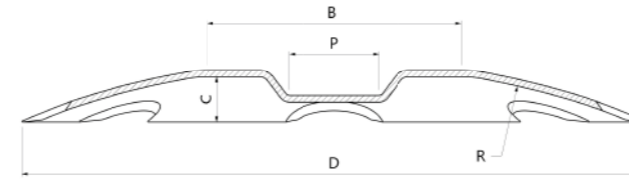

DIAMETER D		Mould Cod. 047		Mould Cod. 114	
		P	80	3" 5/62	80
B	225	8" 55/64	225	8" 55/64	
R	730	28" 47/64	730	28" 47/64	
		C		C	
mm	in	mm	in	mm	in
510	20"	59	2" 21/64	-	-
560	22"	36	1" 27/64	-	-
620	24,5"	45,5	1" 51/64	-	-
645	25"	65	2" 9/16	-	-
735	29"	-	-	62	2" 7/16

PUNCHED CONCAVE DISC
DISCO CONCAVO PUNZONATO

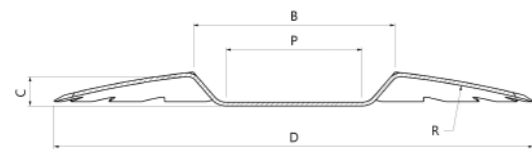

DIAMETER D		Mould Cod. 093	
		P	145
B	210	8" 17/64	
R	1000	39" 3/8	
		C	
mm	in	mm	in
410	16"	15	19/32
460	18"	20	25/32
510	20"	26	1" 1/32
560	22"	33,5	1" 5/16

DISC WITH FLAT CENTER
DISCO CON CENTRO PIANO

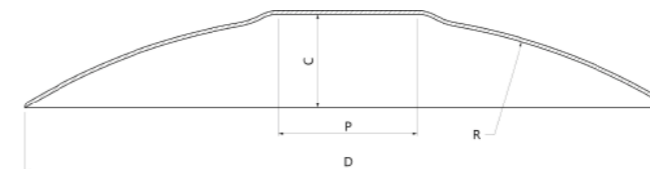

DIAMETER DIAMETRO D		Mould Cod. 010	
		P	150
R	670	26" 3/8	
		C	
mm	in	mm	in
410	16"	35	1" 3/8
460	18"	43,5	1" 23/32
510	20"	53	2" 3/32
530	21"	57	2" 1/4
560	22"	64	2" 33/64
610	24"	76	2" 63/64
660	26"	89	3" 1/2
710	28"	105	4" 9/64



**CONIC DISCS
DISCHI CONICI**

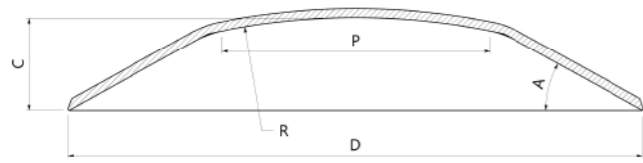

DIAMETER D		Mould Cod. 020		Mould Cod. 020-1	
		P	R	P	R
		260	10° 15/64	284	11° 3/16
		650	25° 19/32	600	24° 1/64
		A 26,5°		29°	
		C		C	
mm	in	mm	in	mm	in
510	20"	62,5	2" 29/64	82,5	3" 1/4
560	22"	72,5	2" 55/64	96,5	3" 51/64
610	24"	85	3" 11/32	110	4" 21/64
660	26"	97,5	3" 27/32	124	4" 7/8
710	28"	108,5	4" 17/64	-	-
760	30"	122,5	4" 53/64	-	-

**12 WAVES DISC WITH FLAT CENTER
DISCO A 12 ONDE CON CENTRO PIANO**

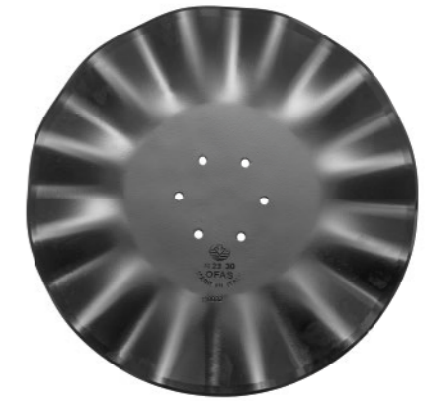
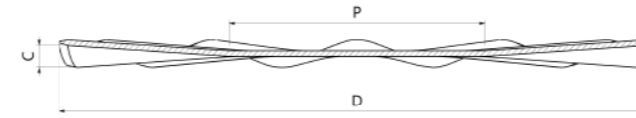

DIAMETER DIAMETRO D		Mould Cod. 079	
		P	C
		228	8" 31/32
		C	
mm	in	mm	in
460	18"	15,5	39/64
560	22"	22	55/64

**8 WAVES DISCS WITH FLAT CENTER
DISCHI A 8 ONDE CON CENTRO PIANO**

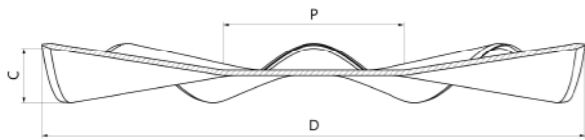

Mould Cod. 012

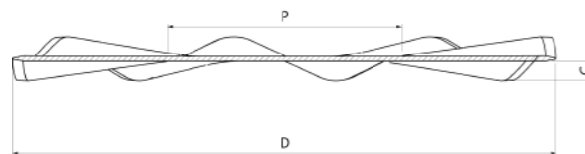

Mould Cod. 69



DIAMETER D		Mould Cod. 012			
		P	C		C
		170	6" 11/16	220	8" 21/32
mm	in	mm	in	mm	in
325	12,5"	23	29/32	-	-
410	16"	35	1" 3/8	-	-
460	18"	43	1" 11/16	-	-
470	18,5"	45	1" 49/64	-	-
510	20"	50	1" 31/32	-	-
530	21"	52	2" 3/64	-	-
560	22"	-	-	59	2" 21/64
580	23"	-	-	63	2" 15/32
630	25"	-	-	70	2" 3/4

DIAMETER D		Mould Cod. 069	
		P	C
		220	8" 11/16
mm	in	mm	in
520	20,5"	20	25/32
580	23"	24,5	31/32
630	25"	28	1" 7/64

**SIX POINTED STAR DISC
DISCO A STELLA SEI PUNTE**

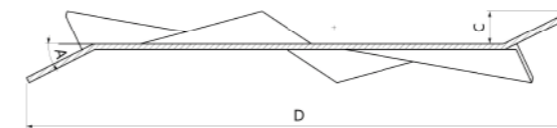

DIAMETER DIAMETRO D		Mould Cod. 021	
		A	C
		27°	
mm	in	mm	in
520	20,5"	29	1" 9/64

The points can turn left or right.
Le punte possono girare a destra o a sinistra.



CROSS CUTTER DISC
DISCO TAGLIO OBLIQUO

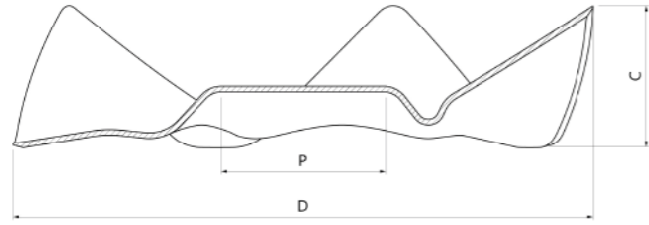

DIAMETER DIAMETRO D		Mould Cod. 128	
		P	145 5" 45/64
		C	
mm	in	mm	in
480	19"	113	4" 29/64
500	19,5"	121	4" 49/64

PACKER RING

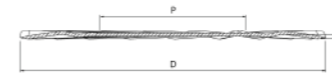

DIAMETER DIAMETRO D		Mould Cod. 051	
		B	358 14" 3/32
		C	
mm	in	mm	in
600	23,5"	36	1" 27/64
700	27,5"	36	1" 27/64

Single half of the disc is provided.
Sold separately and not soldered.

Viene fornita solo una metà del disco.
Venduto separatamente e non saldato.

FLOW DISC
DISCO FLUIZIONE TERRA



DIAMETER DIAMETRO D		Mould Cod. 054		NOTE
		R	695 27" 23/64	
		C		
mm	in	mm	in	
710	28"	97,5	3" 27/32	front & rear
760	30"	113	4" 29/64	front & rear
810	32"	130	5" 1/8	front & rear

WAVED DISC
DISCO A ONDE



DIAMETER D		Mould Cod. 080	
		P	92 3" 5/8
		C	
mm	in	mm	in
460	18"	6	15/64
510	20"	6	15/64
570	22,5"	6	15/64
610	24"	6	15/64



STANDARD FLAT DISCS DISCHI PIANI STANDARD



Plain Disc
Disco liscio



Notched Disc
Disco dentato

DIAMETER D		THICKNESS		PLAIN DISC Weight		NOTCHED DISC Weight*	
mm	in	mm	in	kg	lb	kg	lb
406	16"	3	1/8	2,85	6,28	2,74	6,04
406	16"	3,5	9/64	3,34	7,36	3,21	7,08
406	16"	4	5/32	3,83	8,44	3,68	8,11
406	16"	5	13/64	4,78	10,54	4,59	10,12
433	17"	4	5/32	4,25	9,37	4,08	8,99
433	17"	4,5	11/64	4,79	10,56	4,60	10,14
450	17,5"	4	5/32	4,4	9,7	4,22	9,30
457	18"	3,5	9/64	4,08	9	3,92	8,62
457	18"	4	5/32	4,68	10,32	4,49	9,90
457	18"	4,5	11/64	5,27	11,62	5,06	11,16
457	18"	5	13/64	5,84	12,87	5,61	12,35
457	18"	6	15/64	6,97	15,37	6,69	14,75
457	18"	7	9/32	8,09	17,84	7,77	17,11
470	18,5"	5	13/64	5,9	13,01	5,66	12,48
508	20"	3,5	9/64	5,23	11,53	5,02	11,07
508	20"	4	5/32	5,97	13,16	5,73	12,63
508	20"	4,5	11/64	6,7	14,77	6,43	14,11
508	20"	5	13/64	7,43	16,38	7,13	15,72
508	20"	6	15/64	8,84	19,49	8,49	18,70
582	23"	4	5/32	7,89	17,4	7,57	16,69
582	23"	4,5	11/64	8,86	19,53	8,51	18,74
582	23"	5	13/64	9,82	21,65	9,43	20,77
582	23"	6	15/64	11,7	25,79	11,23	24,76
610	24"	4,5	11/64	9,75	21,49	9,36	20,64
610	24"	5	13/64	10,81	23,83	10,38	22,86
610	24"	6	15/64	12,89	28,42	12,37	27,27
635	25"	5	13/64	11,58	25,53	11,12	24,49
635	25"	6	15/64	13,99	30,84	13,43	29,61
660	26"	6	15/64	16	35,27	15,36	33,86
660	26"	8	5/16	21,5	47,4	20,64	45,50
711	28"	6	15/64	19,5	42,99	18,72	41,27
711	28"	8	5/16	26,4	58,2	25,34	55,86
762	30"	8	5/16	31	68,34	29,76	65,61
762	30"	10	25/64	38	83,78	36,48	80,42
813	32"	8	5/16	33,5	73,85	32,16	70,90
813	32"	10	25/64	41,5	91,5	39,84	87,83
914	36"	12	15/32	65	143,5	62,40	137,57

*weights of the notched discs are indicative: deviations occur due to the number and type of notch

*i pesi dei dischi dentati sono indicativi: si verificano scostamenti dovuti al numero e tipologia di dentatura

CENTER HOLE OPTIONS OPZIONI DI FORO CENTRALE

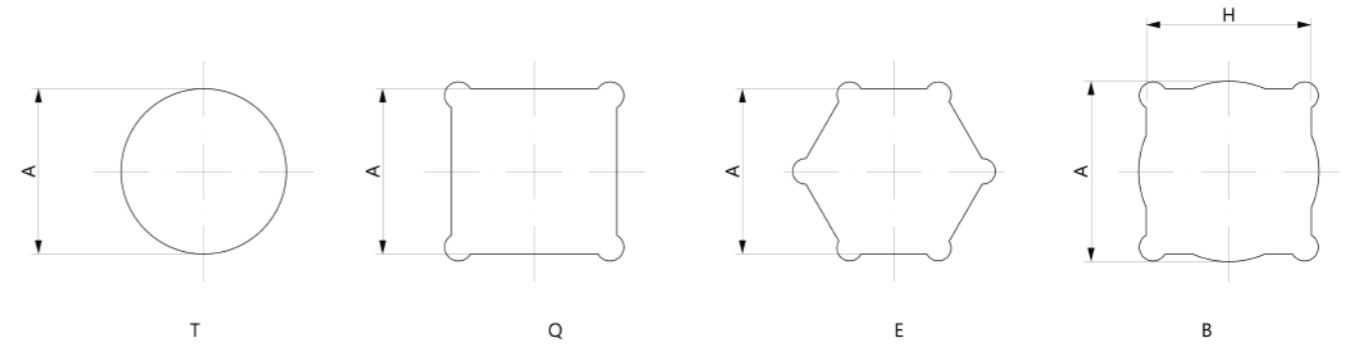

HOLE COD	A									
	mm	in	mm	in	mm	in	mm	in	mm	in
T	20	25/32	30	1" 3/16	35	1" 3/8	40	1" 37/64	45	1" 49/64
Q	23	29/32	26	1" 1/32	29	1" 9/64	31	1" 7/32	33	1" 19/64
E	37	1" 29/64	41	1" 39/64	67	2" 41/64	88	3" 15/32	90	3" 35/64

HOLE COD	A									
	mm	in	mm	in	mm	in	mm	in	mm	in
T	50	1" 31/32	55	2" 11/64	60	2" 23/64	65	2" 9/16	70	2" 3/4
Q	41	1" 39/64	46	1" 13/16	51	2" 1/64	56	2" 13/64	-	-
E	92	3" 5/8	98	3" 55/64	-	-	-	-	-	-

HOLE COD	A		H	
	mm	in	mm	in
B	35	1" 3/8	39	1" 17/32
	41	1" 39/64	46	1" 13/16
	27	1" 1/16	29	1" 9/64

Particular holes can be designed.
Possono essere creati particolari fori.



DISC NOTCHES: STANDARD
DENTATURE DISCO: STANDARD

DIAMETER D		NUMBER OF NOTCHES	A		B	
mm	in		mm	in	mm	in
410	16"	8	80	3" 5/32	35	1" 3/8
460	18"	9	80	3" 5/32	35	1" 3/8
510	20"	10	80	3" 5/32	35	1" 3/8
560	22"	10	80	3" 5/32	35	1" 3/8
610	24"	10	80	3" 5/32	45	1" 49/64
660	26"	12	90	3" 35/64	45	1" 49/64
710	28"	13	90	3" 35/64	45	1" 49/64
760	30"	13	90	3" 35/64	45	1" 49/64
810	32"	14	90	3" 35/64	40	1" 37/64
860	34"	15	90	3" 35/64	40	1" 37/64
960	37,5"	16	90	3" 35/64	40	1" 37/64
1016	40"	17	90	3" 35/64	40	1" 37/64

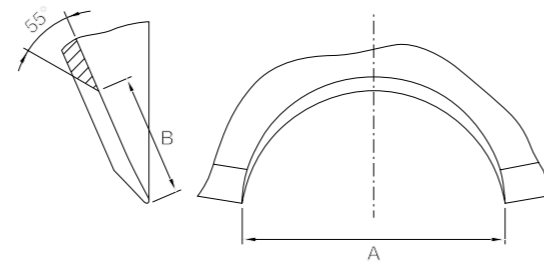

Only for exterior edge.
Solo per bordo esterno.

DISC NOTCHES: LARGE
DENTATURE DISCO: GRANDI

DIAMETER D		NUMBER OF NOTCHES	A		B	
mm	in		mm	in	mm	in
610	24"	8	90	3" 35/64	50	1" 31/32
660	26"	8	90	3" 35/64	50	1" 31/32
710	28"	10	90	3" 35/64	50	1" 31/32
760	30"	10	90	3" 35/64	50	1" 31/32
810	32"	12	90	3" 35/64	50	1" 31/32
960	37,5"	12	90	3" 35/64	50	1" 31/32

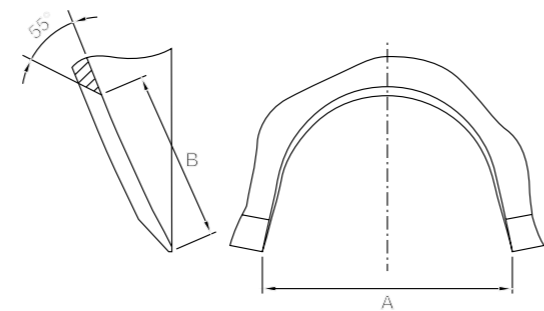

Only for exterior edge.
Solo per bordo esterno.

DISC NOTCHES: MINI
DENTATURE DISCO: PICCOLE

DIAMETER D		NUMBER OF NOTCHES	A		B	
mm	in		mm	in	mm	in
410	16"	20	20	25/32	10	25/64
460	18"	20	20	25/32	11	7/16
510	20"	20	20	25/32	12	15/32

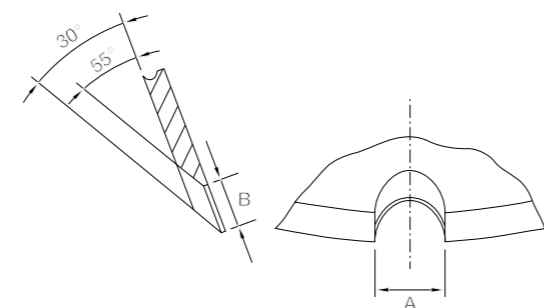

Only for exterior edge.
Solo per bordo esterno.

CONCAVE DISC BEVELS: outside-inside edge of bevel
BISELLI DISCO CONCAVO: bordo esterno-interno del bisello

THICKNESS		L		A		B	
mm	in	mm	in	mm	in	mm	in
2,5	3/32	6	15/64	-	-	1,5	1/16
3	1/8	7	9/32	-	-	1,5	1/16
3,5	9/64	8	5/16	-	-	2	5/64
4	5/32	10	25/64	-	-	2	5/64
4,5	11/64	11	7/16	-	-	2,5	3/32
5	13/64	12	15/32	1,5	1/16	2,5	3/32
6	15/64	12	15/32	1,5	1/16	2,5	3/32
7	9/32	12	15/32	1,5	1/16	2,5	3/32
8	5/16	12	15/32	1,5	1/16	2,5	3/32

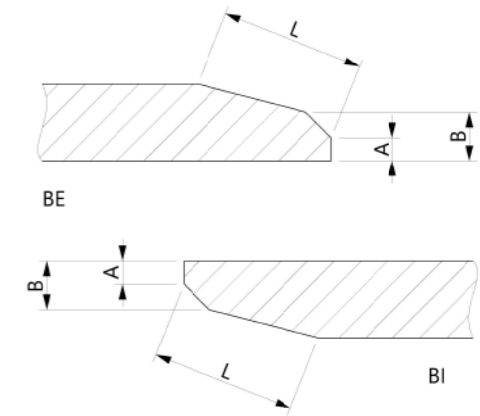

CONCAVE DISC BEVELS: outside-inside bevel RM
BISELLI DISCO CONCAVO: bordo esterno-interno RM

THICKNESS		L		H		A		B	
mm	in	mm	in	mm	in	mm	in	mm	in
4	5/32	10	25/64	3	1/8	1	3/64	2,5	3/32
4,5	11/64	10	25/64	3	1/8	1,1	3/64	3	1/8
5	13/64	12	15/32	4	5/32	1,2	3/64	4	5/32
6	15/64	15	19/32	5	13/64	1,3	3/64	5	13/64
7	9/32	20	25/32	6	15/64	1,5	1/16	6	15/64
8	5/16	20	25/32	7	9/32	2,25	3/32	7	9/32
10	25/64	20	25/32	8	5/16	2,5	3/32	8	5/16
12	15/32	23	29/32	10	25/64	4,25	11/64	10,5	13/32

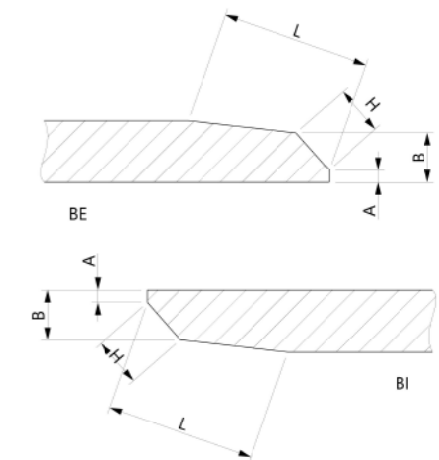

CONCAVE DISC BEVELS: outside bevel 30°
BISELLI DISCO CONCAVO: bordo esterno 30°

THICKNESS		L		H	
mm	in	mm	in	mm	in
3	1/8	3,5	9/64	0,8	1/32
3,5	9/64	4,5	11/64	0,8	1/32
4	5/32	6	15/64	1	3/64
4,5	11/64	7	9/32	1	3/64
5	13/64	8	5/16	1	3/64
6	15/64	10	25/64	1	3/64

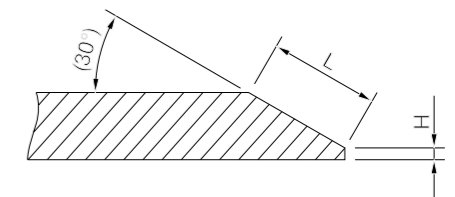



Discs for seeders
Dischi per seminatrici

DISC ASSEMBLIES ASSEMBLAGGI DISCO



Inline Openers
Apertura allineata



Offset Openers
Apertura Sfalsata



Inside Bevel
Bisello interno



Outside Bevel
Bisello esterno



Double Bevel
Doppio bisello

The assembly of the disc with the Hub can be carried out with screws or rivets

L'assemblaggio del disco con l'hub può essere eseguito con viti o con rivetti.

FLAT DISC WITH HUB DISCO PIANO CON HUB

DIAMETER D		THICKNESS		WEIGHT	
mm	in	mm	in	kg	lb
305	12"	2,5	3/32	1,4	3,09
333	13"	3	1/8	2	4,41
345	13,5"	3	1/8	2,2	4,85
351	14"	3,5	9/64	2,7	5,95
381	15"	3,5	9/64	3,1	6,83
406	16"	4	5/32	4,1	9,04
433	17"	4	5/32	4,7	10,36



*For further informations on HUBs please consult "Agri HUB" section.

*Per ulteriori informazioni sugli HUB consultare la sezione "Agri HUB"

STANDARD FLAT DISCS DISCHI PIANI STANDARD



Plain Disc
Disco Liscio



Notched Disc
Disco dentato

DIAMETER D		THICKNESS		PLAIN DISC Weight		NOTCHED DISC Weight	
mm	in	mm	in	kg	lb	kg	lb
255	10"	2,5	3/32	0,92	2,03	0,88	1,94
255	10"	3,5	9/64	1,22	2,69	1,17	2,58
282	11"	3	1/8	1,35	2,98	1,30	2,87
305	12"	2,5	3/32	1,35	2,98	1,30	2,87
305	12"	3	1/8	1,78	3,92	1,71	3,77
305	12"	4	5/32	2	4,41	1,92	4,23
333	13"	2,5	3/32	1,62	3,57	1,56	3,44
333	13"	3	1/8	1,81	3,99	1,74	3,84
333	13"	4	5/32	2,46	5,42	2,36	5,20
343	13,5"	3	1/8	2	4,41	1,92	4,23
343	13,5"	4	3/32	2,7	5,95	2,59	5,71
351	14"	3	1/8	2,13	4,69	2,04	4,50
351	14"	3,5	9/64	2,5	5,51	2,40	5,29
351	14"	4	5/32	2,86	6,3	2,75	6,06
351	14"	5	13/64	3,56	7,85	3,42	7,54
381	15"	3	1/8	2,5	5,51	2,40	5,29
381	15"	3,5	9/64	2,87	6,33	2,76	6,08
381	15"	4	5/32	3,28	7,23	3,15	6,94
381	15"	5	13/64	4,15	9,15	3,98	8,77
394	15,5"	4	5/32	3,35	7,38	3,22	7,10
394	15,5"	5	13/64	4,35	9,59	4,18	9,22
406	16"	3	1/8	2,85	6,28	2,74	6,04
406	16"	3,5	9/64	3,34	7,36	3,21	7,08
406	16"	4	5/32	3,83	8,44	3,68	8,11
406	16"	5	13/64	4,78	10,54	4,59	10,12
433	17"	4	5/32	4,25	9,37	4,08	8,99
433	17"	4,5	11/64	4,79	10,56	4,60	10,14
450	17,5"	4	5/32	4,4	9,7	4,22	9,30
457	18"	3,5	9/64	4,08	9	3,92	8,64
457	18"	4	5/32	4,68	10,32	4,49	9,90
457	18"	4,5	11/64	5,27	11,62	5,06	11,16
457	18"	5	13/64	5,84	12,87	5,61	12,37
457	18"	6	15/64	6,97	15,37	6,69	14,75
457	18"	7	9/32	8,09	17,84	7,77	17,13
470	18,5"	5	13/64	5,9	13,01	5,66	12,48
508	20"	3,5	9/64	5,23	11,53	5,02	11,07
508	20"	4	5/32	5,97	13,16	5,73	12,63
508	20"	4,5	11/64	6,7	14,77	6,43	14,18
508	20"	5	13/64	7,43	16,38	7,13	15,72
508	20"	6	15/64	8,84	19,49	8,49	18,72

*weights of the notched discs are indicative: deviations occur due to the number and type of notch

*i pesi dei dischi dentati sono indicativi: si verificano scostamenti dovuti al numero e tipologia di dentatura

NOTCHED DISCS DISCHI DENTATI

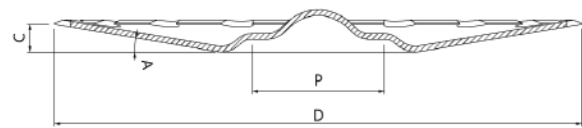

Mould Cod. 090

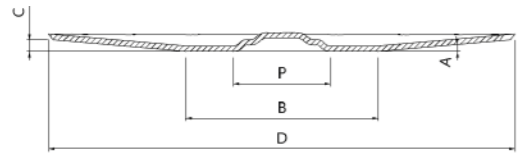

Mould Cod. 091



DIAMETER D		Mould Cod. 090		Mould Cod. 091 CONCAVE*	
		P	A	P	A
		115	4" 17/32	85	3" 11/32
				170	6" 11/16
			9,5°		5°
		C		C	
mm	in	mm	in	mm	in
370	14,5"	16	5/8	9	23/64
405	16"	19	3/4	10,5	13/32
410	16"	19,5	49/64	10,5	13/32
430	17"	21	53/64	11,5	29/64
445	17,5"	22,5	57/64	12,5	31/64

*Mould code 091 is also proposed flat (same D, always P:85 mm / 3" 11/32 in, C:12 mm / 15/32 in)

*Stampo cod. 091 viene proposto anche piano (stesso D, sempre P:85 mm / 3" 11/32 in, C:12 mm / 15/32 in)

55 WAVES DISC DISCO A 55 ONDE



DIAMETER D		Mould Cod. 077	
		P	C
		348	13" 45/64
		60	2" 23/64
		C	
mm	in	mm	in
508	20"	1,5	1/16
582	22"	1,5	1/16

50 WAVES DISCS DISCHI A 50 ONDE

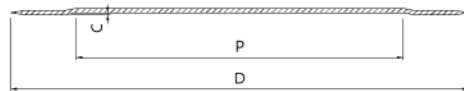

DIAMETER D		Mould Cod. 031	
		P	C
		308	12" 1/8
		C	
mm	in	mm	in
406	16"	1,5	1/16
423	16,5"	1,5	1/16
433	17"	1,5	1/16
457	18"	1,5	1/16
508	20"	1,5	1/16

DIAMETER DIAMETRO D		Mould Cod. 036	
		P	C
		290	11" 27/64
		C	
mm	in	mm	in
410	16"	2	5/64

WAVES DISC DISCO A ONDE

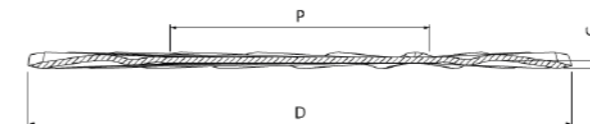

DIAMETER D		Mould Cod. 063	
		P	C
		220	8" 21/32
		C	
mm	in	mm	in
380	15"	6,5	1/4
406	16"	7,5	19/64
430	17"	8,3	21/64
450	17,5"	9	23/64
460	18"	9,3	23/64
510	20"	11	7/16
560	22"	12,5	31/64

PUNCHED FLAT DISC
DISCO PIANO PUNZONATO

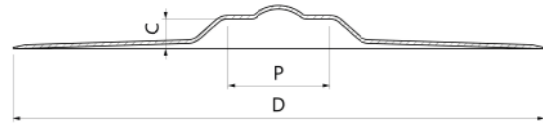

DIAMETER D		Mould Cod. 094	
		P 73	2" 7/8
		C	
mm	in	mm	in
305	12"	20	25/32
333	13"	20,4	51/64
343	13,5"	20,5	13/16
350	13,5"	20,6	13/16
380	15"	21	53/64

DISCS WITH FLAT CENTER
DISCHI CON CENTRO PIANO

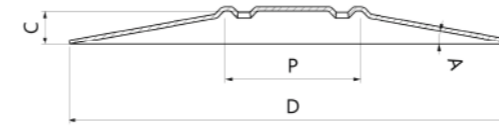

Mould Cod. 039

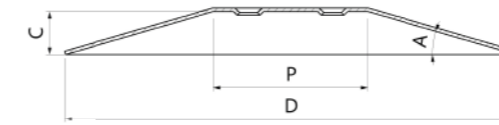

Mould Cod. 029



DIAMETER DIAMETRO D		Mould Cod. 039	
		P 95	3" 47/64
		A	10°
		C	
mm	in	mm	in
320	12,5"	24	15/16
350	13,5"	27	1" 1/16

DIAMETER D		Mould Cod. 029	
		P 116	4" 9/16
		A	16°
		C	
mm	in	mm	in
305	12"	28	1" 7/64
325	12,5"	31	1" 7/32
330	13"	31,5	1" 15/64

DISC WITH FLAT CENTER
DISCO CON CENTRO PIANO

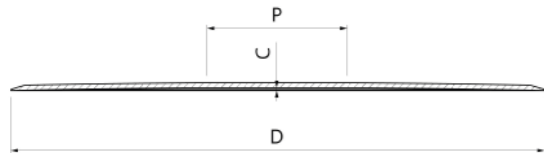

DIAMETER D		Mould Cod. 067	
		P 100	3" 15/16
		C	
mm	in	mm	in
305	12"	1	3/64
345	13,5"	1	3/64
383	15"	1,5	1/16
390	15,5"	1,5	1/16

STAR DISC - ROW CLEAN
DISCO A STELLA "ROW CLEAN"



DIAMETER DIAMETRO D		Mould Cod. 00P	
		P -	-
		A	
mm	in	mm	in
351	14"	6	15/64
351	14"	8	5/16

DISC NOTCHES: STANDARD
DENTATURE DISCO: STANDARD

DIAMETER D		NUMBER OF NOTCHES	A		B	
mm	in		mm	in	mm	in
280	11"	8	60	2" 23/64	35	1" 3/8
305	12"	8	60	2" 23/64	35	1" 3/8
333	13"	9	60	2" 23/64	35	1" 3/8
351	14"	10	60	2" 23/64	35	1" 3/8
381	15"	10	60	2" 23/64	35	1" 3/8
406	16"	10	60	2" 23/64	35	1" 3/8
433	17"	10	80	3" 5/32	40	1" 37/64
457	18"	12	80	3" 5/32	40	1" 37/64
508	20"	12	80	3" 5/32	40	1" 37/64

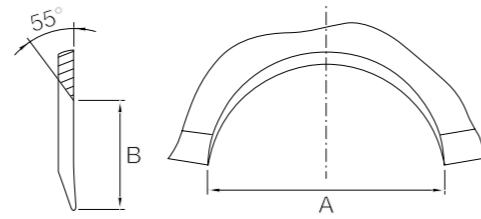

FLAT DISC BEVELS: simple 15° bevel
BISELLI DISCO PIANO: bordo semplice 15°

THICKNESS		L		H	
mm	in	mm	in	mm	in
2	5/64	4,5	11/64	0,8	1/32
2,5	3/32	6	15/64	0,8	1/32
3	1/8	7,5	19/64	0,8	1/32
3,5	9/64	9,5	3/8	0,8	1/32
4	5/32	11	7/16	1	3/64
4,5	11/64	13	33/64	1	3/64
5	13/64	15	19/32	1	3/64
6	15/64	18	45/64	1	3/64
7	9/32	20	25/32	1,2	3/64
8	5/16	22	55/64	1,6	1/16

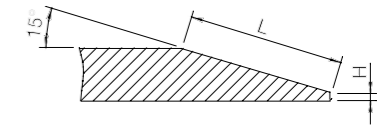

DISC NOTCHES: MINI
DENTATURE DISCO: PICCOLE

DIAMETER D		NUMBER OF NOTCHES	A		B	
mm	in		mm	in	mm	in
406	16"	20	22	55/64	11	7/16
457	18"	21	22	55/64	11	7/16
508	20"	22	22	55/64	11	7/16

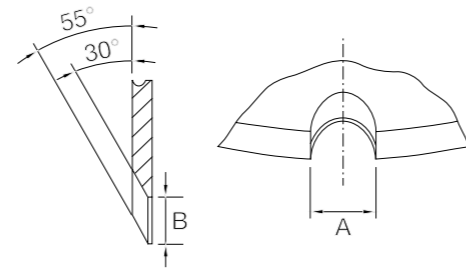

FLAT DISC BEVELS: simple 30° bevel
BISELLI DISCO PIANO: bordo semplice 30°

THICKNESS		L		H	
mm	in	mm	in	mm	in
3	1/8	3,5	9/64	0,8	1/32
3,5	9/64	4,5	11/64	0,8	1/32
4	5/32	5	13/64	0,8	1/32
4,5	11/64	6	15/64	1	3/64
5	13/64	7	9/32	1	3/64
6	15/64	8	5/16	1	3/64

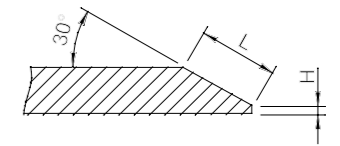

DISC NOTCHES: SPECIAL V SHAPE
DENTATURE DISCO: SPECIALE FORMA V

DIAMETER D		NUMBER OF NOTCHES	A		B	
mm	in		mm	in	mm	in
457	18"	14	62,5	2" 29/64	25	63/64
508	20"	14	62,5	2" 29/64	25	63/64

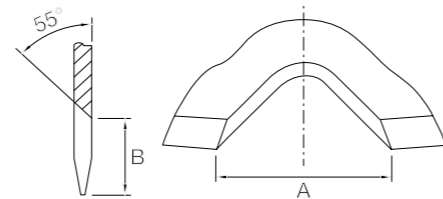

FLAT DISC BEVELS: double 20° bevel
BISELLI DISCO PIANO: bordo doppio 20°

THICKNESS		L		H	
mm	in	mm	in	mm	in
2	5/64	3,5	9/64	0,8	1/32
2,5	3/32	4,5	11/64	0,8	1/32
3	1/8	5,5	7/32	0,8	1/32
3,5	9/64	7	9/32	0,8	1/32
4	5/32	8,5	21/64	0,8	1/32
4,5	11/64	10	25/64	0,8	1/32
5	13/64	11,5	29/64	0,8	1/32
6	15/64	14	35/64	0,8	1/32
7	9/32	17	43/64	0,8	1/32
8	5/16	19,5	49/64	0,8	1/32

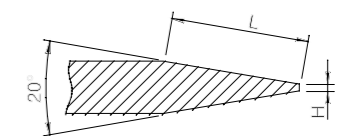



Rapid tillage
Lavorazione rapida

RAPID TILLAGE SYSTEMS: SUPPORTS FOR CULTIVATOR DISC
SISTEMA DI LAVORAZIONE VELOCE: SUPPORTO PER DISCO COLTIVATORE

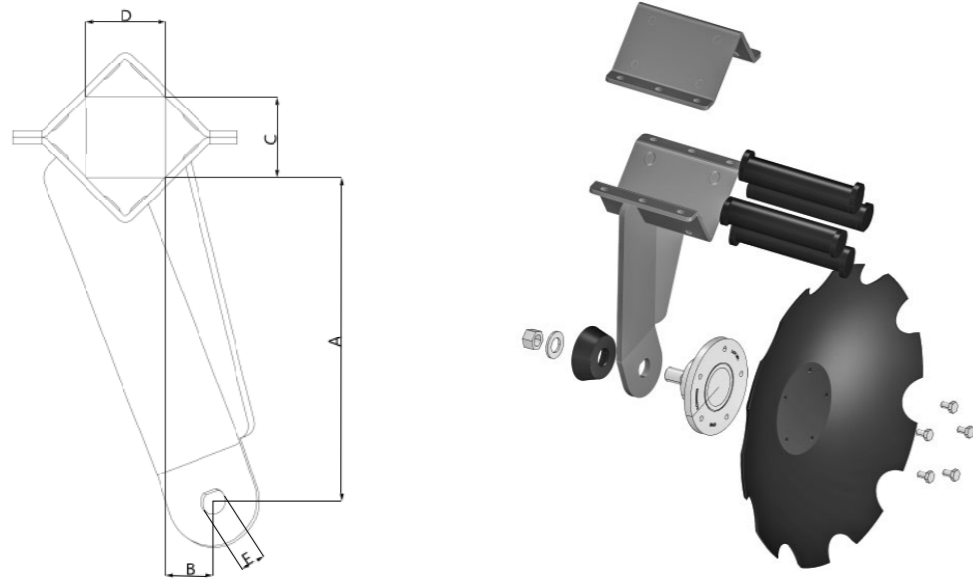

COD	A	B	C	D	E	DESCRIPTION	MATCHED HUB	SUGGESTED DISC (disc diameter - mm)
	mm	mm	mm	mm	mm			
RT000015	392	40	100	100	30	REAR	CC0000080	560
RT000016	392	40	100	100	30	FRONT	CC0000080	
RT000017	392	40	100	100	28	REAR	CC0000055 CC0000056 CC0000057	610
RT000018	392	40	100	100	28	FRONT	CC0000055 CC0000056 CC0000057	
RT000019	392	40	100	100	36	REAR	CC0000058	460
RT000020	392	40	100	100	36	FRONT	CC0000058	
RT000021	330	65	80	80	28	REAR	CC0000055 CC0000056 CC0000057	460
RT000022	330	65	80	80	28	FRONT	CC0000055 CC0000056 CC0000057	
RT000023	360	65	80	80	28	REAR	CC0000055 CC0000056 CC0000057	460
RT000024	360	65	80	80	28	FRONT	CC0000055 CC0000056 CC0000057	
RT000025	360	65	80	80	30	REAR	CC0000080	510
RT000026	360	65	80	80	30	FRONT	CC0000080	
RT000027	360	65	80	80	36	REAR	CC0000058	
RT000028	360	65	80	80	36	FRONT	CC0000058	

With the RT System is included the central block with closing support and the hub protection cap.*

Con il sistema RT è compreso il blocco centrale con il supporto di chiusura e la cuffia di protezione del mozzo.*

*Screw kit on request
 * Kit viti su richiesta

SILENT BLOCKS AVAILABLE
AMMORTIZZATORI IN GOMMA DISPONIBILI



COD	D	L
	mm	mm
G-SB35X180	35	180
G-SB35X200	35	200
G-SB40X180	40	180
G-SB40X200	40	200
G-SB40X205	40	205
G-SB40X230	40	230
G-SB50X190	50	190
G-SB50X210	50	210
G-SB50X240	50	240

Different diameters and lengths can be mounted.

Possono essere montati diversi diametri e lunghezze.

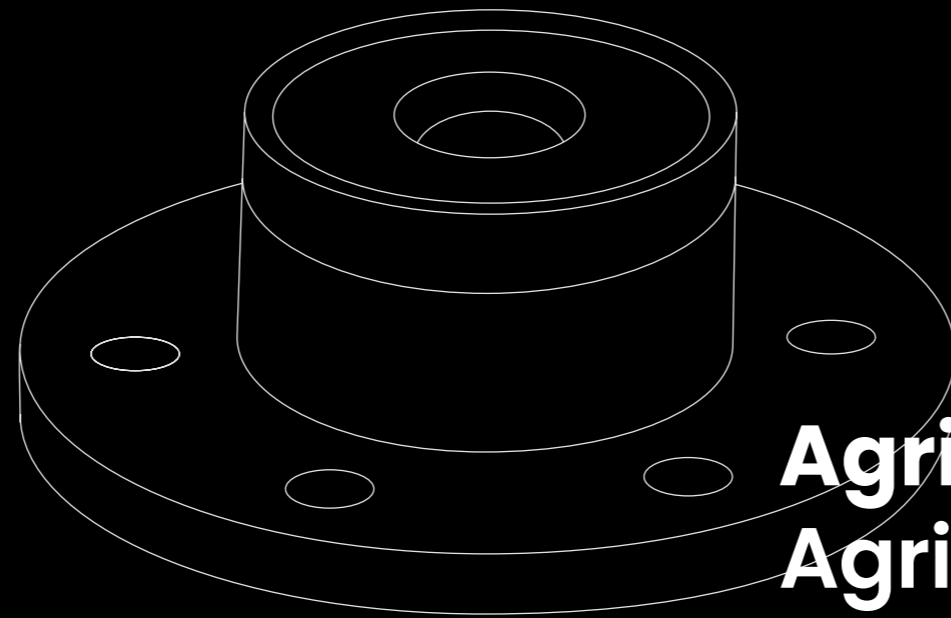

Agri Hub for Rapid Tillage
Agri Hub per dischi Rapid Tillage

AGRI HUB: PRODUTTIVITÀ AGRI HUB: PRODUCTIVITY

CONDIZIONI OTTIMALI IDEAL CONDITIONS	CONDIZIONI PESANTI (terreno duro, abrasivo, bagnato e fangoso) HEAVY CONDITIONS (hard, abrasive and muddy ground)
100.000 hectares	10.000 hectares
250.000 acres	25.000 acres

AGRI HUB: VANTAGGI AGRI HUB: ADVANTAGES

PRODUTTORE PRODUCER
Aumento della qualità e dell'affidabilità della macchina Increase of the quality and reliability of the machine
Riduzione dei costi di progettazione, testinf, assemblaggio e garanzia Reduction of project, testing, assembly and warranty costs
Rafforzamento dell'immagine dell'azienda e della sostenibilità ambientale Reinforcement of the company reputation and of the environmental sustainability

PRODUTTORE PRODUCER
Aumento della produttività della macchina Increase of the machine productivity
Esente da manutenzione durante il lavoro stagionale per mantenere in funzione l'attrezzatura Maintenance free during the seasonal application guaranteeing the functionality of the machines
Istallazione e sostituzione dell'unità semplice e veloce Easy and simple installation and replacement of the unit
Riduzione dei costi di manutenzione e possesso Cost reduction for maintenance and ownership
Sistema cuscinetti-guarnizioni perfettamente integrato Perfectly integrated bearing-seal system
Ingrassato e protetto per l'intera durata dell'unità Lubricated and protected for the entire life cycle of the unit
La speciale tenuta fornisce un'eccellente protezione contro fango, polvere, pietra, acqua, ecc. The special mechanical seal provides an excellent protection against mud, dust, stones, water, etc.
Riduzione del rischio di perdite di lubrificante nei campi Reduction of lubricant loss in the fields
Rivestimento speciale per proteggere dalla ruggine durante il funzionamento e i tempi di fermo dopo la stagione Special protection coating against rust during the application and the downtime after the season

CONSUMO DI LUBRIFICANTE (10 ANNI VITA/MACCHINA) LUBRICANT CONSUMPTION (10 YEARS LIFESPAN/MACHINE)

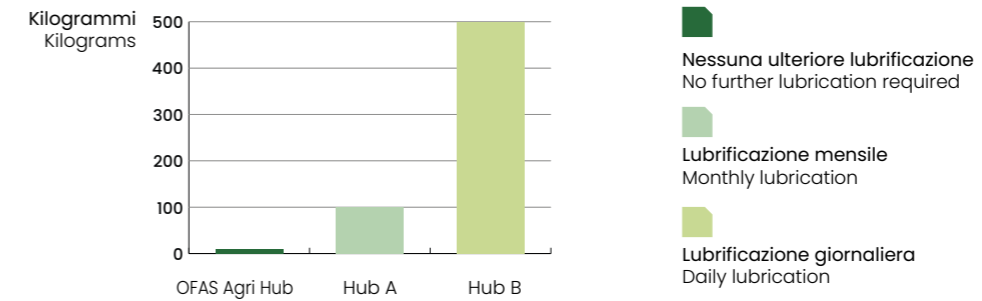

AUMENTO DELLE PRODUTTIVITÀ FINO AL 150% INCREASE OF PRODUCTIVITY UP TO 150%

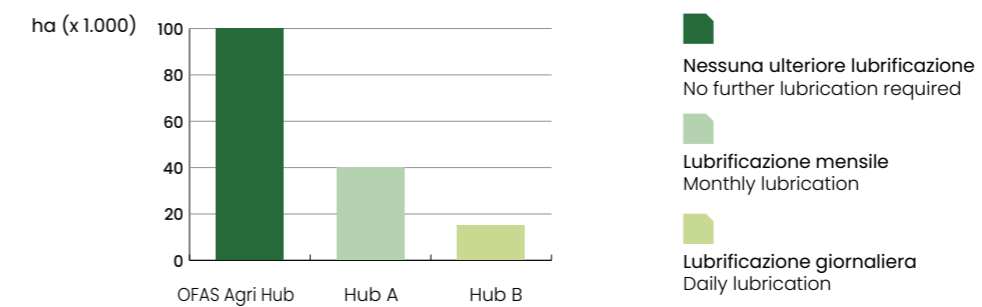

La riduzione delle rotture dei cuscinetti triplica la durata del sistema rispetto alle soluzioni tradizionali.

The reduction of bearing breakage triples the lifespan of the system comparing to traditional solutions.

COSTO DI POSSESSO (10 ANNI VITA/MACCHINA) COST OF OWNERSHIP (10 YEARS LIFESPAN/MACHINE)

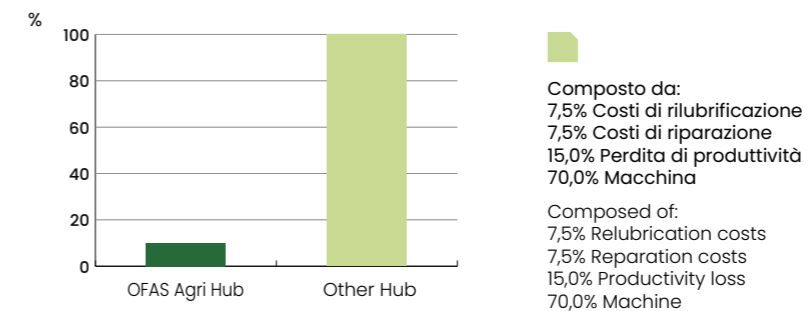

Nessuna operazione di reingrassaggio e meno danneggiamenti dei cuscinetti possono far risparmiare più di mezz'ora di manutenzione ogni giorno.

No required relubrication and less damages of the bearings lead to a reduction of the maintenance time of more than 30 minutes per day.

COSTI DI GESTIONE PER IL PRODUTTORE FINO AL 90% OPERATING COSTS PRODUCER UP TO 90%

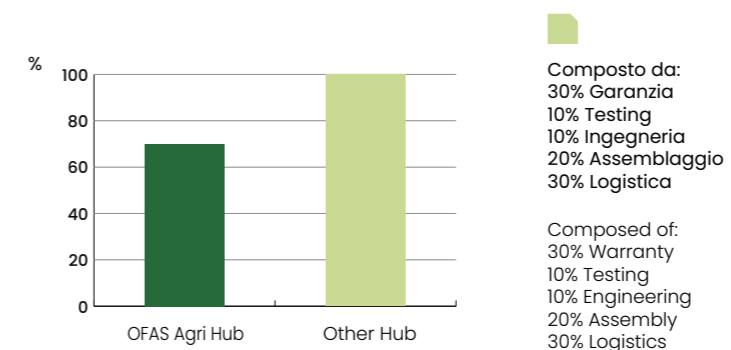

Sostituire diversi componenti con un'unità integrata riduce notevolmente i costi per il produttore della macchina.

Replacing various components with an integrated unit reduces costs significantly for the producer of the machine.

AGRI HUB: CONDIZIONI TIPICHE DI UTILIZZO
AGRI HUB: TYPICAL APPLICATION CONDITIONS

Diametro disco: da 300 a 650 mm Disc diameter: from 300 to 650 mm
Velocità disco: 90-350 rpm Disc speed: 90-350 rpm
Velocità trattore: 5-20 km/h Tractor speed: 5-20 km/h
Capacità di carico: max 3 kN (applicati sulla sommità del disco) Load capacity: max 3 kN (applied on top of the disc)
Temperatura: -20 ÷ 50 °C (statico -50 °C) Temperature: -20 ÷ 50 °C (static -50 °C)

AGRI HUB: TEST IN CAMPO E LABORATORIO
AGRI HUB: FIELD AND LABORATORY TESTS

TIPOLOGIA TEST TEST TYPE	RISULTATO RESULT
Dissodatura in campo aperto Tilling in open field	+ PRODUTTIVITÀ + PRODUCTIVITY
Dissodatura con fango e liquame Tilling with mud and slurry	+ PRODUTTIVITÀ + PRODUCTIVITY
Basse temperature con partenza a -20° C Low temperatures starting from -20° C	+ PRODUTTIVITÀ + PRODUCTIVITY
Test di attrito Friction test	+ RIDUZIONE DELL'IMPATTO AMBIENTALE + REDUCTION OF THE ENVIRONMENTAL IMPACT
Protezione dalla corrosione Corrosion protection	+ QUALITÀ +QUALITY
Tenuta all'acqua Water tightness	+ RIDUZIONE DELL'IMPATTO AMBIENTALE + REDUCTION OF THE ENVIRONMENTAL IMPACT
Pressione dell'aria Air pressure	+ RIDUZIONE DELL'IMPATTO AMBIENTALE + REDUCTION OF THE ENVIRONMENTAL IMPACT

AGRI HUB: TENUTE DEI CUSCINETTI - PANORAMICA DELLE PRESTAZIONI
AGRIHUB: SEAL OF THE BEARING - PERFORMANCE OVERVIEW

PRESTAZIONI DI TENUTA NEL TEST SU FANGO
SEAL PERFORMANCE IN THE MUD TEST

Il nostro centro di ricerca e sviluppo utilizza test su fango per simulare le prestazioni del mozzo nelle condizioni di utilizzo reali. Il test viene eseguito per determinare l'efficacia del "mud-block" dell'Agri Hub contro l'intrusione di contaminanti in condizioni aggressive.

Our research and development department undertakes mud tests to simulate the performance of the bearings under real agricultural conditions. The test determinates the efficiency of the Agri Hub seal against the intrusion of contaminants in aggressive conditions.

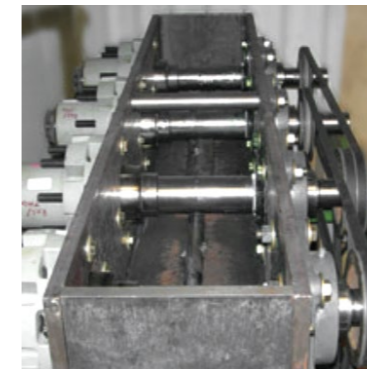
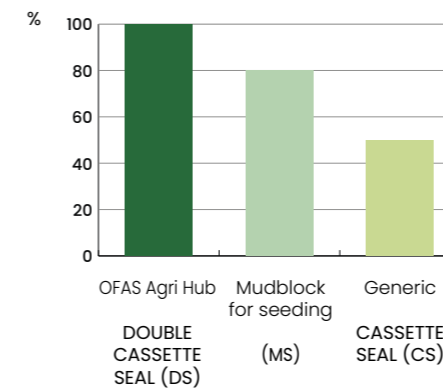

HUB 16



COD	C	D	E	L	HOLES
	mm	mm	mm	mm	mm
CC0000093	80	100	16,053	36	N° 6 - M8x1,25
CC0000105	78	105	16,053	36	N° 6 - Ø 9,5

*Shown drawings are a simplified graphic representation.

*I disegni riportati sono una rappresentazione grafica semplificata.



COD	C	D	E	L	HOLES
	mm	mm	mm	mm	mm
CC0000120	60	74,4	16	23	N6 - M8x1

*Shown drawings are a simplified graphic representation.

*I disegni riportati sono una rappresentazione grafica semplificata.

HUB 20



COD	A	B	C	D	E	L	HOLES
	mm	mm	mm	mm	mm	mm	mm
CC0000073	20	18,5	80	100	M16x2	73	N° 5 - Ø 8,5
CC0000088	20	18,5	80	100	M16x2	73	N° 6 - Ø 8,5
CC0000092	20	18,5	80	100	M16x2	73	N° 6 - M8x1,25

*Shown drawings are a simplified graphic representation.

*I disegni riportati sono una rappresentazione grafica semplificata.



COD	C	D	E	L	R	HOLES
	mm	mm	mm	mm	mm	mm
CC0000108	80	100	M12x1,75	51,3	378	N° 5 - Ø 9

*Shown drawings are a simplified graphic representation.

*I disegni riportati sono una rappresentazione grafica semplificata.



HUB 30



COD	A	B	C	D	E	L	HOLES
	mm	mm	mm	mm	mm	mm	mm
CC0000055	28	25,5	98	117	M22x1,5	100,8	N° 4 - M12x1,25
CC0000056	28	25,5	98	117	M22x1,5	100,8	N° 5 - M12x1,25
CC0000057	28	25,5	98	117	M22x1,5	100,8	N° 6 - M12x1,25
CC0000076	28	26,5	98	117	M24x2	107	N° 6 - M12x1,25
CC0000090	30	27,5	98	117	M24x2	105	N° 4 - M12x1,25

*Shown drawings are a simplified graphic representation.

*I disegni riportati sono una rappresentazione grafica semplificata.

HUB 35

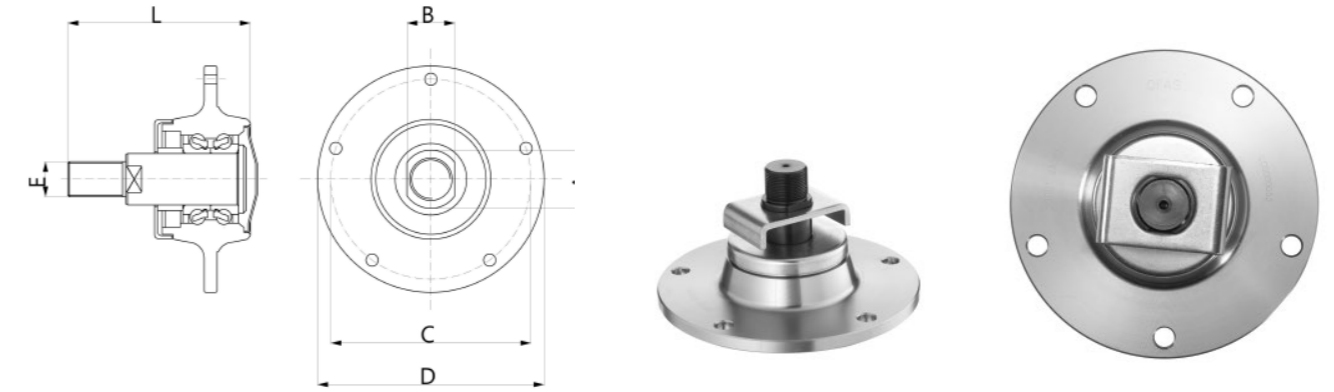

COD	A	B	C	D	E	L	HOLES
	mm	mm	mm	mm	mm	mm	mm
CC0000052	35	30	160	185	M30x1,5 DX	113	N° 5 - Ø12
CC0000054	35	30	160	185	M30x1,5 SX	113	N° 5 - Ø12

*Shown drawings are a simplified graphic representation.

*I disegni riportati sono una rappresentazione grafica semplificata.



COD	A	B	C	D	E	L	HOLES
	mm	mm	mm	mm	mm	mm	mm
CC0000080	35	28	112	140	M24x2	98,5	N° 5 - M12x1,5
CC0000081	35	30	115	140	M30x1,5	115	N° 4 - M12x1,25
CC0000125	35	28	150	178	M34x2	116	N° 6 - M12x1,5

*Shown drawings are a simplified graphic representation.

*I disegni riportati sono una rappresentazione grafica semplificata.



HUB 40



COD	A	B	C	D	E	L	HOLES
	mm	mm	mm	mm	mm	mm	mm
CC0000058	40	33,5	140	178	M27x2	111	N° 5 - M12x1,25
CC0000127	40	25,5	98	117	M22x1,5	100,8	N° 4 - M12x1,25

*Shown drawings are a simplified graphic representation.

*I disegni riportati sono una rappresentazione grafica semplificata.

UCF



COD	A	B	C	D	E	L
	mm	mm	mm	mm	mm	mm
CC0000060	142,9	142,9	174,6	174,6	60	69,1
CC0000062	92,1	92,1	117,5	117,5	35	44,5
CC0000064	111,1	111,1	142,9	142,9	50	54,8
CC0000069	101,6	101,6	130,2	130,2	40	51,4

*Shown drawings are a simplified graphic representation.

*I disegni riportati sono una rappresentazione grafica semplificata.

SAMPLES OF POSSIBLE DESIGN ESEMPI DI POSSIBILI DESIGN



CC000026

CC000094

CC000103

CC000099

CC0000106





Subsoiler blades
Lame per ripuntatore

BLADES 800-100 (front&rear)
ANCORA "BLADES" 800-1000 (anteriore e posteriore)

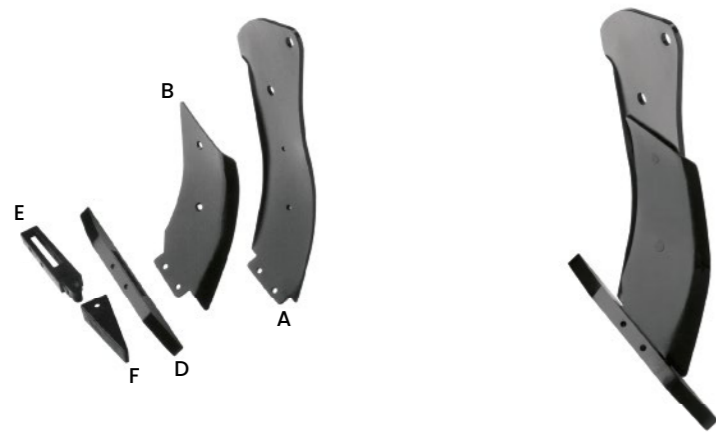

COD		A	B	HOLES	THICKNESS	WEIGHT
		mm	mm	mm	mm	kg
A	OF802	300	820	30	15	23,20
	OF803	300	820	30	15	23,20
	OF1002	304	1020	30	20	40,00
	OF1003	304	1020	30	20	40,00

COD		A	B	HOLES	THICKNESS	WEIGHT
		mm	mm	mm	mm	kg
C	OF804	295	295	16	8	5,05
	OF805	295	295	16	8	5,05
	OF806	295	465	16	8	7,83
B	OF809	295	465	16	8	7,83
	OF1006	295	465	16	8	7,80
	OF1009	295	465	16	8	7,80

COD		A	B	HOLES	THICKNESS	WEIGHT
		mm	mm	mm	mm	kg
D	OF807	580	40	16	60	7,20
E	OF810	314	60	16	60	3,80
F	OF811	147	67	16	60	1,85
G	OF808	- Assembly kit -				

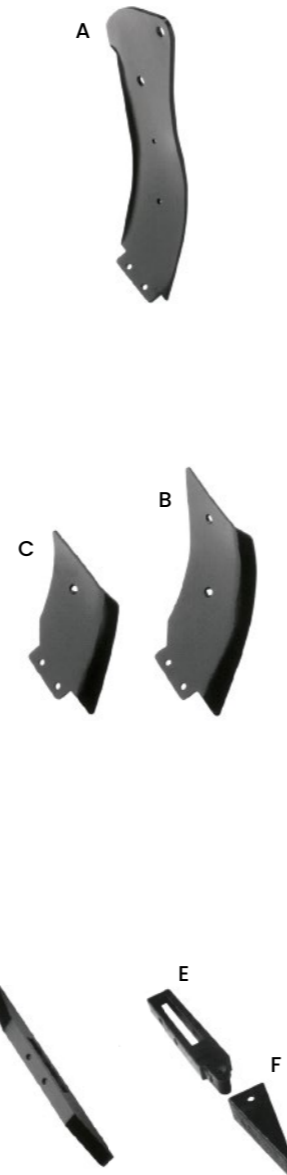

BLADES 600 (front & rear)
ANCORA "BLADES" 600 (anteriore e posteriore)

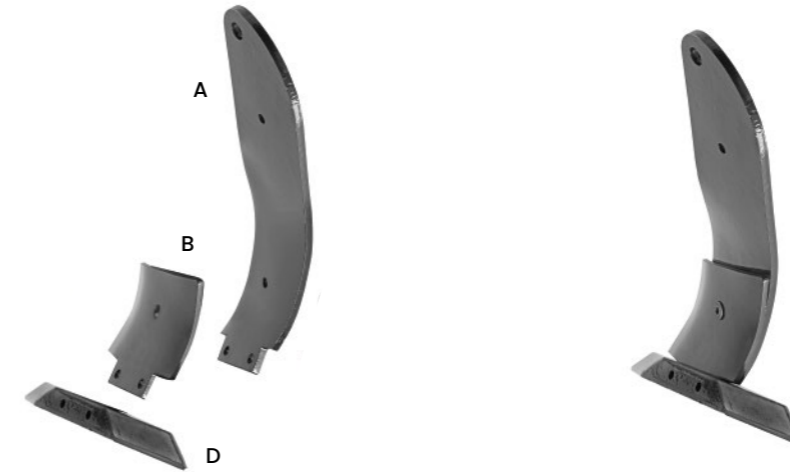

COD		A	B	HOLES	THICKNESS	WEIGHT
		mm	mm	mm	mm	kg
A	OF600	295	465	25	15	10,500
	OF601	295	465	25	15	10,500

COD		A	B	HOLES	THICKNESS	WEIGHT
		mm	mm	mm	mm	kg
B	OF604	250	230	14	8	2,650
	OF605	250	230	14	8	2,650

COD		A	B	HOLES	THICKNESS	WEIGHT
		mm	mm	mm	mm	kg
D	OF607	50	510	14	50	4,230
	OF608	- Assembly kit -				

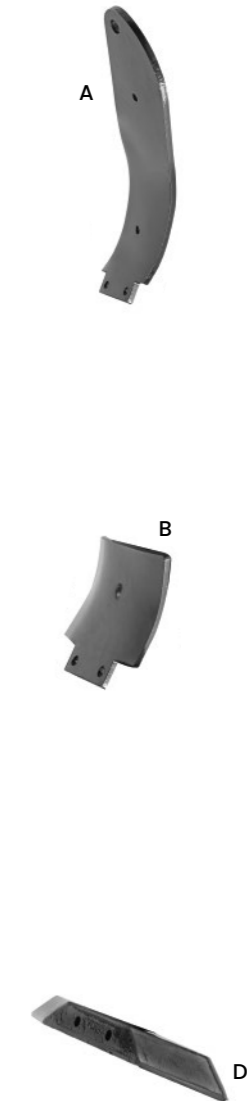

**CULTIVATOR TINE
LAMA RIPUNTATORE**



COD		WEIGHT	DESCRIPTION
A	OFK730	11,600 kg	DELTAFLEX Type Anchor
B	OFK731	2,300	DELTAFLEX Central Mouldboards
C	OFK732	1,750	DELTAFLEX Central Point
D	OFK733	2,140	DELTAFLEX Side Wing DX
E	OFK734	2,140	DELTAFLEX Side Wing SX

**CULTIVATOR TINE
LAMA RIPUNTATORE**



COD		WEIGHT	DESCRIPTION
A	OFH740	12,00 kg	H Type High Anchor
B	OFH741	1,70	H Central Point 12 mm
C	OFH742	2,00	H Central Anchor Mouldboards DX
D	OFH743	2,00	H Central Anchor Mouldboards SX
E	OFH744	2,00	H Anchor Wing DX
F	OFH745	2,00	H Anchor Wing SX



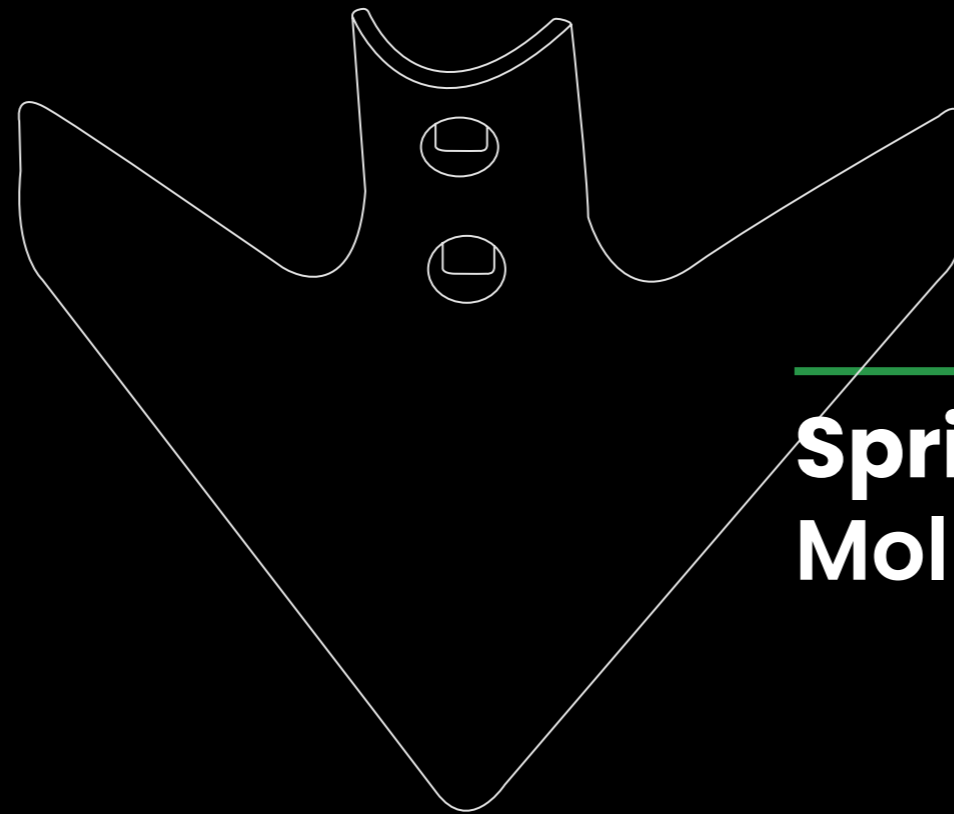

Spring tines and sweeps **Molle e vomeri a lancia**

**WEEDER TINE
MOLLA SARCHIATRICE**

COD	A	B	SECTION	WEIGHT
391MF	mm 170	mm 185	mm 32x12	kg 1,95

*clamp type 370 & 371
*staffa tipo 370 & 371

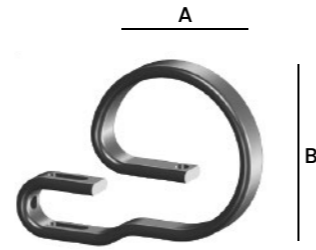

**LEG FOR CENTRAL POINT
GAMBO CENTRALE**

COD	A	B	SECTION	WEIGHT
392MF	mm 64	mm 340	mm 32x10	kg 0,85

*clamp type 370 & 371
*staffa tipo 370 & 371

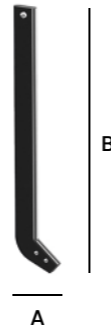

**LEG FOR LATERAL POINT
GAMBO LATERALE**

COD	A	B	SECTION	WEIGHT
393MF	mm 32	mm 350	mm 32x10	kg 0,835

*clamp type 370 & 371
*staffa tipo 370 & 371



**ROUND NUT FOR RIGID LEG
DADO DI FISSAGGIO GAMBO**

COD	WEIGHT
395MF	kg 0,22

*clamp type 370 & 371
*staffa tipo 370 & 371



**SPRING TINES
MOLLE**

COD	A	B	SECTION	WEIGHT
360 MF 10	mm 325	mm 540	mm 32x10	kg 2,7
360 MF 12	mm 325	mm 540	mm 32x12	kg 3,2

*clamp type 370 & 371
*staffa tipo 370 & 371

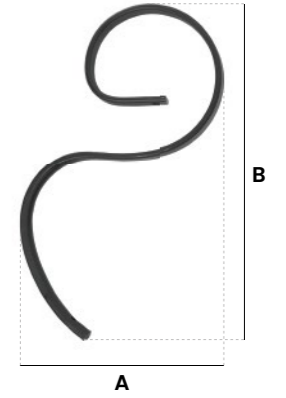

**HELPER FOR SPRING TINE
RINFORZO MOLLA**

COD	A	B	SECTION	WEIGHT
365 RI 32X10	mm 180	mm 210	mm 32x10	kg 1,45

*clamp type 370 & 371
*staffa tipo 370 & 371

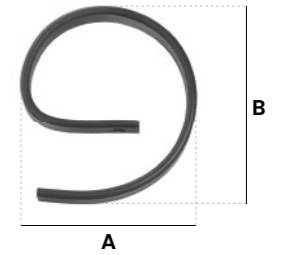

**HELPER WITH EYE FOR SPRING TINE
RINFORZO MOLLA CON OCCHIO**

COD	A	B	SECTION	WEIGHT
366 RIO 32X10	mm 185	mm 180	mm 32x10	kg 1,5

*clamp type 370 & 371
*staffa tipo 370 & 371

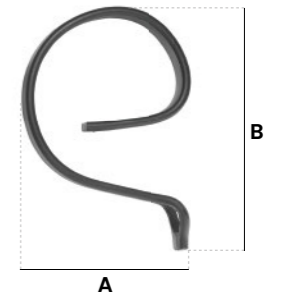

**SPRING TINES FOR CULTIVATORS
MOLLA PER VIBROCOLTIVATORI**

COD	A	B	SECTION	WEIGHT	DESCRIPTION
361 MFSV	mm 190	mm 400	mm 32x10	kg 1,67	without reversible point
361 MFCV	mm 190	mm 400	mm 32x10	kg 1,88	with reversible point

*clamp type 370 & 371
*staffa tipo 370 & 371

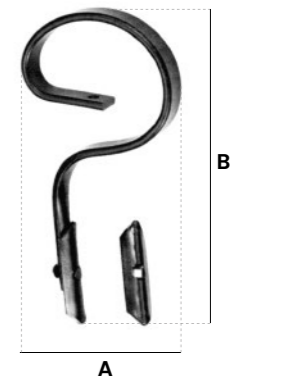

SPRING TINES FOR CULTIVATORS MOLLA PER VIBROCOLTIVATORI

COD	A	B	SECTION	WEIGHT	DESCRIPTION
362 MFSV	225	525	32x12	2,45	without reversible point
362 MFCV	225	525	32x12	2,93	with reversible point
376 MFSV	225	525	32x10	2,12	without reversible point
376 MFCV	225	525	32x10	2,51	with reversible point

*clamp type 370 & 371
*staffa tipo 370 & 371

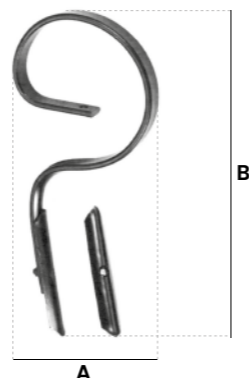

CLAMPS 370 & 371 STAFFE DI FISSAGGIO 370 & 371

COD.	SECTION	MATCHED S.TINE	HELPER S. TINE	MACHINE FRAME	WEIGHT	DESCRIPTION
370 SM 50	50x6	32x10	-	50x12	0,24	single blade
370 SM 51	50x6	32x10	-	50x15	0,25	single blade
370 SM 52	50x6	32x10	-	50x15	0,25	single blade
370 SB 53	50x6	32x10	32x10	50x12	0,25	double blade
370 SB 54	50x6	32x10	32x10	50x15	0,25	double blade
370 SB 55	50x6	32x10	32x10	50x15	0,26	double blade
370 SM 60	50x6	32x10	-	50x50	0,32	single blade
370 SM 61	50x6	32x10	-	50x50	0,33	single blade
370 SB 70	50x6	32x10	32x10	50x50	0,33	double blade
370 SB 71	50x6	32x10	32x10	50x50	0,33	double blade
371 SMR 50	50x8	32x10	-	50x12	0,295	single blade
371 SMR 51	50x8	32x10	-	50x15	0,3	single blade
371 SMR 52	50x8	32x12	-	50x15	0,305	single blade
371 SBR 53	50x8	32x10	32x10	50x12	0,305	double blade
371 SBR 54	50x8	32x10	32x10	50x15	0,31	double blade
371 SBR 55	50x8	32x12	32x10	50x15	0,315	double blade



LEVELING TINES MOLLE LIVELLATRICI

COD	A	B	SECTION	WEIGHT
360 MF 45X10	234	509	45x10	3,18
364 MFL	234	509	45x10	3,16
365 MFL	260	516	45x10	3,35

*clamp type 386
*staffa tipo 386



LEVELING TINES MOLLE LIVELLATRICI

COD	A	B	SECTION	WEIGHT
366 MFL	260	516	80x10	6,1
367 MFL	260	500	80x10	6,02
368 MFL	260	385	80x10	5,14

*clamp type 386
*staffa tipo 386



CLAMP 386 STAFFA DI FISSAGGIO 386

COD.	SECTION	MATCHED S.TINE	HELPER S. TINE	MACHINE FRAME	WEIGHT	DESCRIPTION
386 SM 60	110x10	80x12	-	60x60	1,36	single blade
386 SM 70	110x10	80x12	-	70x70	1,51	single blade
386 SM 80	110x10	80x12	-	80x80	1,79	single blade
386 BB 50	110x10	80x12	8x10	50x50	1,42	double blade
386 BB 60	110x10	80x12	8x10	60x70	1,61	double blade
386 BB 70	110x10	80x12	8x10	70x80	1,83	double blade



SPRING TINES FOR CULTIVATORS MOLLA PER VIBROCOLTIVATORI

COD	A	B	SECTION	WEIGHT
391 MFS	325	660	45x12	5
394 MFS	325	660	45x12	5,75

*clamp type 385
*staffa tipo 385



HELPERS WITH EYE FOR SPRING TINE RINFORZI MOLLA CON OCCHIO

COD	A	B	SECTION	WEIGHT
392 MRS	215	300	45x10	2,6

*clamp type 385
*staffa tipo 385

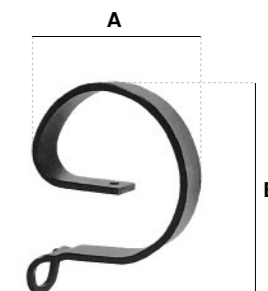

CLAMP 385
STAFFA DI FISSAGGIO 385

COD.	SECTION	MATCHED S.TINE	HELPER S. TINE	MACHINE FRAME	WEIGHT	DESCRIPTION
385 SM 70	70x8	45x12	-	50x50	0,59	single blade
385 SM 71	70x8	45x12	-	60x60	0,68	single blade
385 SM 72	70x8	45x12	-	65x65	0,71	single blade
385 SM 73	70x8	45x12	45x10	50x50	0,63	double blade
385 SM 74	70x8	45x12	45x10	60x60	0,72	double blade
385 SM 75	70x8	45x12	45x10	65x65	0,75	double blade



SPRING TINES
MOLLE

COD	A	B	SECTION	WEIGHT
387 MFS	325	730	70x12	9,415
388 MFS	325	780	80x12	11

*clamp type 387
*staffa tipo 387



HELPERS WITH EYE FOR SPRING TINE
RINFORZI MOLLA CON OCCHIO

COD	A	B	SECTION	WEIGHT
388 RIO	290	370	70x10	5,7
389 RIO	290	370	80x10	5,9

*clamp type 387
*staffa tipo 387

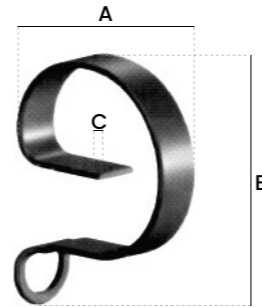

CLAMP 387
STAFFA DI FISSAGGIO 387

COD.	SECTION	MATCHED S.TINE	HELPER S. TINE	MACHINE FRAME	WEIGHT	DESCRIPTION
387 SM 50	110x10	70x12	-	50x50	1,36	single blade
387 SM 60	110x10	70x12	-	60x60	1,51	single blade
387 SM 70	110x10	70x12	-	70x70	1,79	single blade
387 SM 80	110x10	70x12	-	80x80	2,35	single blade
387 BB 50	110x10	70x12	8x10	50x50	1,42	double blade
387 BB 60	110x10	70x12	8x10	60x60	1,61	double blade
387 BB 70	110x10	70x12	8x10	70x70	1,83	double blade



DOUBLE TINES
MOLLE A DOPPIA SPIRA

COD	A	B	SECTION	WEIGHT
364 MQB DX	365	455	25x25	8,2
364 MQB SX	365	455	25x25	8,2
367 MQB DX	365	535	30x30	12,9
367 MQB SX	365	535	30x30	12,9

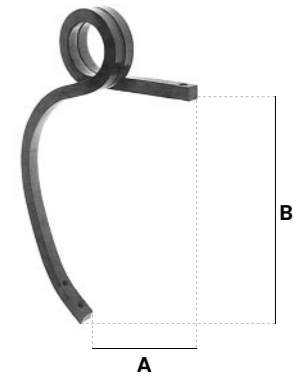

DOUBLE TINES
MOLLE A DOPPIA SPIRA

COD	A	B	SECTION	WEIGHT
368 MQA DX	310	635	30x30	14,1
368 MQA SX	310	635	30x30	14,1

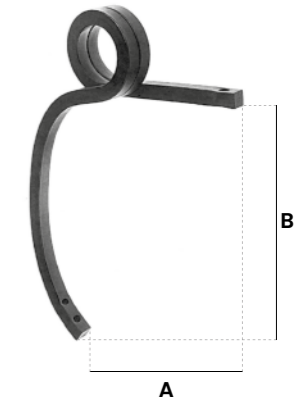

DOUBLE TINES
MOLLE A DOPPIA SPIRA

COD	A	B	SECTION	WEIGHT
369 MQB DX	400	635	35x35	20,5
369 MQB SX	400	635	35x35	20,5

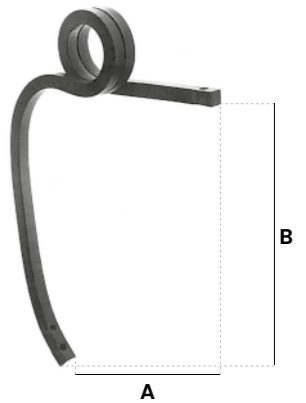

DOUBLE TINES
MOLLE A DOPPIA SPIRA

COD	A	B	SECTION	WEIGHT
370 MQB DX	435	680	40x40	31,8
370 MQB SX	435	680	40x40	31,8

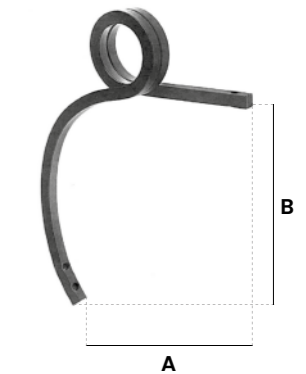

SPRING TINES-SWEEPS
MOLLE - VOMERI LANCIA

**REVERSIBLE POINT
VOMERE REVERSIBILE**

COD	A	B	THICKNESS	WEIGHT
384 MLS	mm 260	mm 60	mm 6	kg 0,65

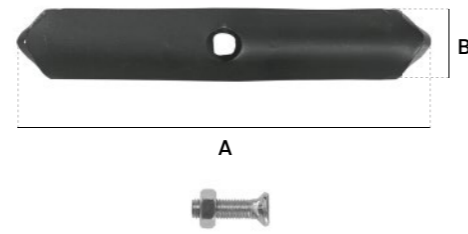

**REVERSIBLE POINTS
VOMERI REVERSIBILI**

COD	A	B	THICKNESS	WEIGHT
385 M 80X12	mm 300	mm 60	mm 10	kg 1,35
386 M 80X12	mm 330	mm 70	mm 12	kg 2,16

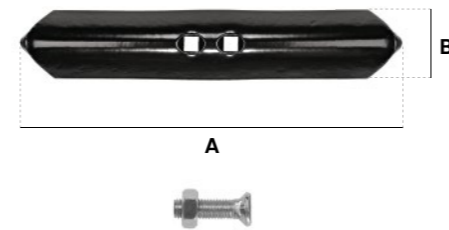

**REVERSIBLE POINTS
VOMERI REVERSIBILI**

COD	A	B	THICKNESS	WEIGHT
190 L 19X5	mm 190	mm 36,5	mm 5	kg 0,28
190L 19X6	mm 190	mm 36,5	mm 6	kg 0,34
195 D 13X5	mm 135	mm 36,5	mm 5	kg 0,18
210 D 210X6	mm 210	mm 36,5	mm 6	kg 0,36

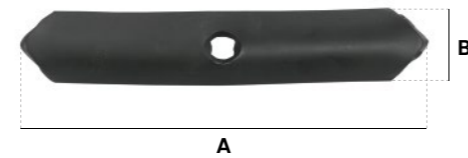

**REVERSIBLE POINTS
VOMERI REVERSIBILI**

COD	A	B	THICKNESS	WEIGHT
190 L 21X8	mm 210	mm 39	mm 8	kg 0,48
190 L 21X6	mm 260	mm 60	mm 6	kg 0,65

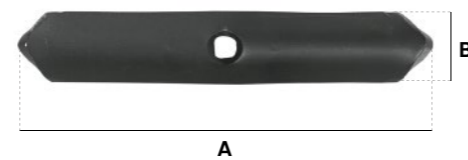

**REVERSIBLE POINTS
VOMERI REVERSIBILI**

COD	A	B	THICKNESS	WEIGHT
190 L 25X6	mm 250	mm 65,5	mm 6	kg 0,64
190 L 28X6	mm 280	mm 65,5	mm 6	kg 0,73

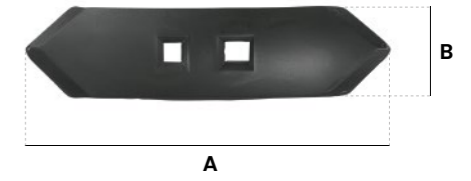

**REVERSIBLE POINTS
VOMERI REVERSIBILI**

COD	A	B	THICKNESS	WEIGHT
7689	mm 485	mm 75	mm 10	kg 2,8
7690	mm 485	mm 75	mm 10	kg 2,8

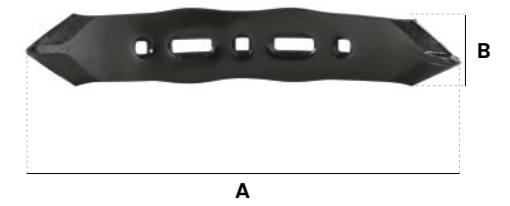

**REVERSIBLE POINT
VOMERE REVERSIBILE**

COD	A	B	THICKNESS	WEIGHT
190L40X16	mm 275	mm 40	mm 16	kg 0,997

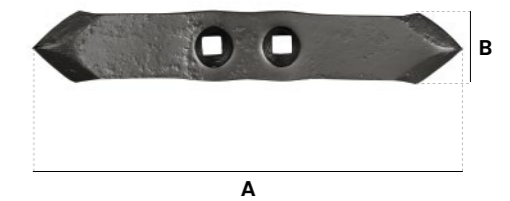

**BOLTS FOR SPRINGS
BULLONI PER MOLLE**

COD	A	B	WEIGHT
380 BU 35	mm 10	mm 35	kg 0,044



**SWEEP POINT
VOMERE A LANCIA**

COD	A	B	THICKNESS	WEIGHT
385 M25	mm 200	mm 200	mm 6	kg 0,75

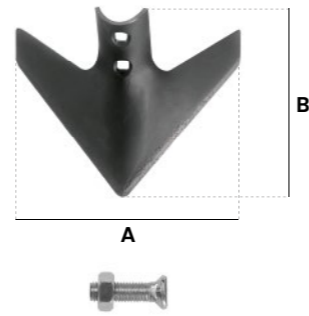

**SWEEP POINTS
VOMERI A LANCIA**

COD	A	B	THICKNESS	WEIGHT
390 VE 200	mm 200	mm 217	mm 8	kg 1,76
390 VE 250	mm 250	mm 217	mm 8	kg 1,9
390 VE 300	mm 300	mm 217	mm 8	kg 2,08
390 VE 350	mm 350	mm 217	mm 8	kg 2,26

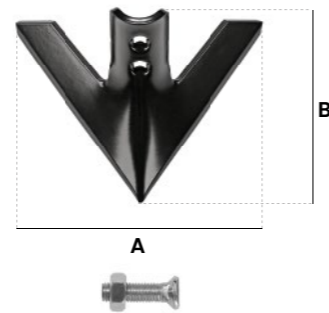

**SWEEP POINT
VOMERE A LANCIA**

COD	A	B	THICKNESS	WEIGHT
120 CM 12	mm 105	mm 120	mm 4,5	kg 0,28

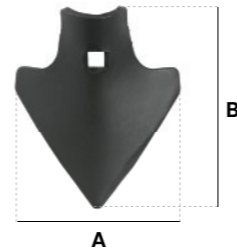

**SWEEP POINTS
VOMERI A LANCIA**

COD	A	B	THICKNESS	WEIGHT
120 CM 15	mm 150	mm 150	mm 4,5	kg 0,43
120 CM 17	mm 175	mm 45	mm 4	kg 0,45
120 CM 20	mm 200	mm 150	mm 4	kg 0,5
120 CM 25	mm 250	mm 185	mm 4	kg 0,59

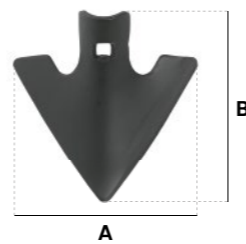

**SWEEP POINTS
VOMERI A LANCIA**

COD	A	B	THICKNESS	WEIGHT
120 TS 20	mm 200	mm 172	mm 4,5	kg 0,59
OF551	mm 70	mm 180	mm 6	kg 0,45
OF552	mm 100	mm 165	mm 8	kg 0,665
OF553	mm 185	mm 180	mm 7	kg 0,86

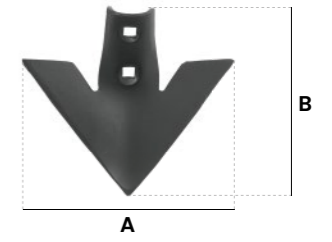

**SWEEP POINTS
VOMERI A LANCIA**

COD	A	B	THICKNESS	WEIGHT
OF140	mm 140	mm 190	mm 6	kg 0,75
OF487	mm 260	mm 225	mm 6	kg 1,35
OF300	mm 300	mm 225	mm 6	kg 1,62

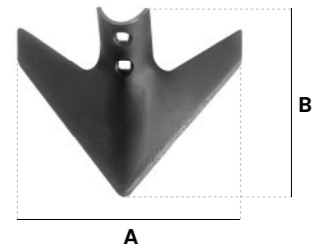

**SWEEP POINT
VOMERE A LANCIA**

COD	A	B	THICKNESS	WEIGHT
130 CE 21T	mm 130	mm 230	mm 6	kg 0,95

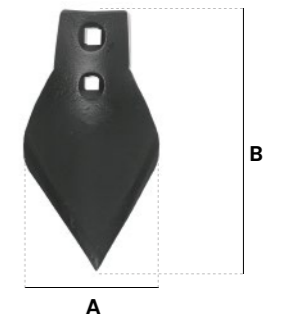

**SWEEP POINT
VOMERE A LANCIA**

COD	A	B	THICKNESS	WEIGHT
130 CE 21	mm 215	mm 230	mm 6	kg 1,15

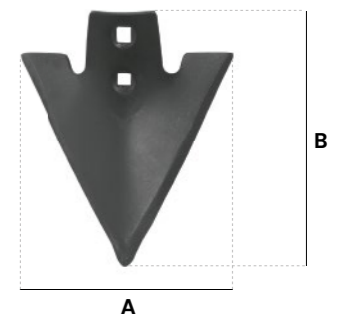

**SWEEP POINTS
VOMERI A LANCIA**

COD	A	B	THICKNESS	WEIGHT
135 CS 22	mm	mm	mm	kg
	220	184	6	1,07
135 CS 26	260	220	6	1,28

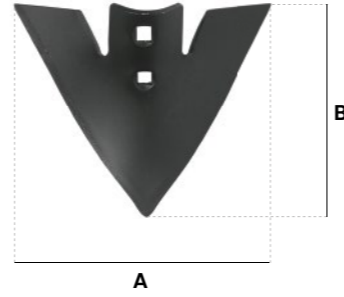

**SWEEP POINTS
VOMERI A LANCIA**

COD	A	B	THICKNESS	WEIGHT
110 CN 12	mm	mm	mm	kg
	120	120	3,5	0,3
110 CN 14	140	135	3,5	0,34
110 CN 16	160	145	3,5	0,36
110 CN 18	180	150	3,5	0,4
110 CN 20	200	165	3,5	0,48
110 CN 22	220	175	3,5	0,5
110 CN 24	240	180	3,5	0,57
110 CN 26	260	190	3,5	0,6
110 CN 28	280	210	3,5	0,63
110 CN 30	300	220	3,5	0,65

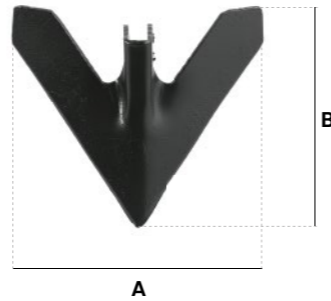

**LATERAL SWEEPS
VOMERI LATERALI**

COD	A	B	THICKNESS	WEIGHT
150 LN 12 DX/SX	mm	mm	mm	kg
	120	220	3,5	0,49
150 LN 14 DX/SX	140	250	3,5	0,53
150 LN 16 DX/SX	160	270	3,5	0,56
150 LN 18 DX/SX	180	300	3,5	0,62
150 LN 20 DX/SX	200	320	3,5	0,65

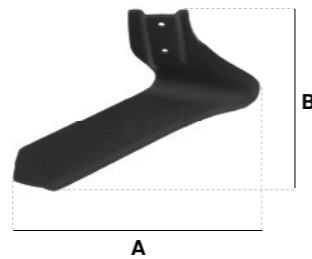

**SWEEP POINTS
VOMERI A LANCIA**

COD	A	B	THICKNESS	WEIGHT
115 CP 22	mm	mm	mm	kg
	220	210	5	0,95
115 CP 26	260	230	5	1,1
115 CP 30	300	260	5	1,3
115 CP 35	350	300	5	1,4

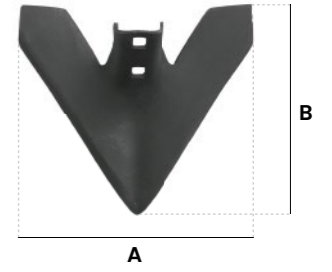

**SWEEP POINT
VOMERE A LANCIA**

COD	A	B	THICKNESS	WEIGHT
OF136X5WR	mm	mm	mm	kg
	240	230	6	1,39

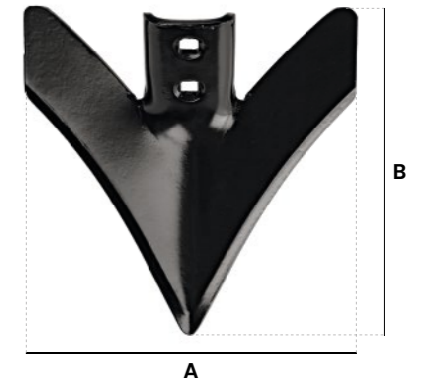

**SWEEP POINT
VOMERE A LANCIA**

COD	A	B	THICKNESS	WEIGHT
OF8533	mm	mm	mm	kg
	515	400	6	3,72

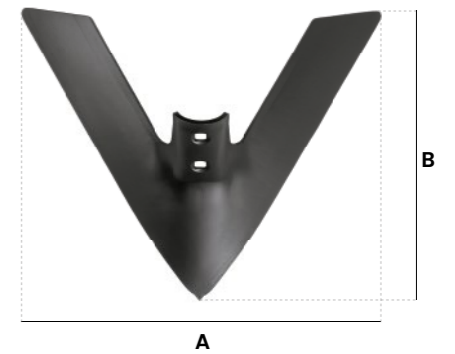

**LATERAL SWEEPS
VOMERE LATERALE**

COD	A	B	THICKNESS	WEIGHT
155 LP 22 DX	mm	mm	mm	kg
	240	330	5	1,8
155 LP 22 SX	240	330	5	1,8

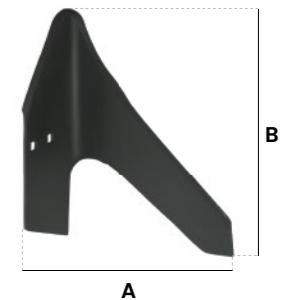

**FLAT CENTRAL SWEEPS
VOMERI A LANCIA PIANO**

COD	A	B	THICKNESS	WEIGHT
125 CF 18	mm	mm	mm	kg
125 CF 18	180	190	3,5	50xBOX
125 CF 28	280	245	4	25xBOX

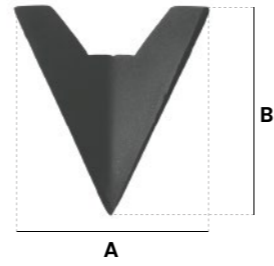

**LATERAL SWEEPS
VOMERI LATERALI**

COD	A	B	THICKNESS	WEIGHT
160 LF 12 DX	mm	mm	mm	kg
160 LF 12 DX	120	230	3,5	0,7
160 LF 12 SX	120	230	3,5	0,7
160 LF 17 DX	185	255	4,5	1,15
160 LF 17 SX	185	255	4,5	1,15

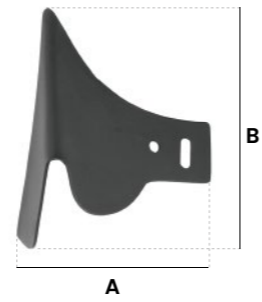

**SWEEP POINTS
VOMERI A LANCIA**

COD	A	B	THICKNESS	WEIGHT
180 V 18	mm	mm	mm	kg
180 V 18	180	170	6	0,9
180 V 20	200	190	6	1,05
180 V 22	220	210	6	1,28
180 V 24	240	240	6	1,6
180 V 27	270	270	6	1,82

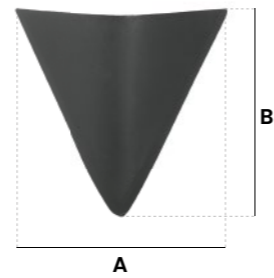

**SWEEP POINT
VOMERE A LANCIA**

COD	A	B	THICKNESS	WEIGHT
180 V 30	mm	mm	mm	kg
180 V 30	300	320	6	2,7

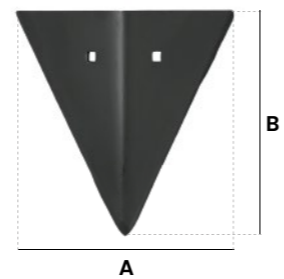

**FULLER
VOMERE CENTRALE RICOLMATORE**

COD	A	B	THICKNESS	WEIGHT
175 CR 34	mm	mm	mm	kg
175 CR 34	330	335	4,5	2,4
OF7304	300	430	6	3,83
OF7305	460	500	6	5,7

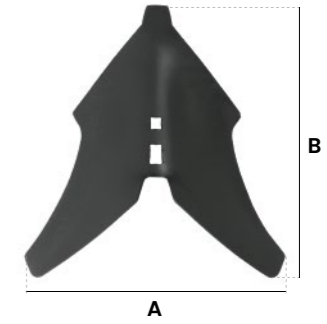

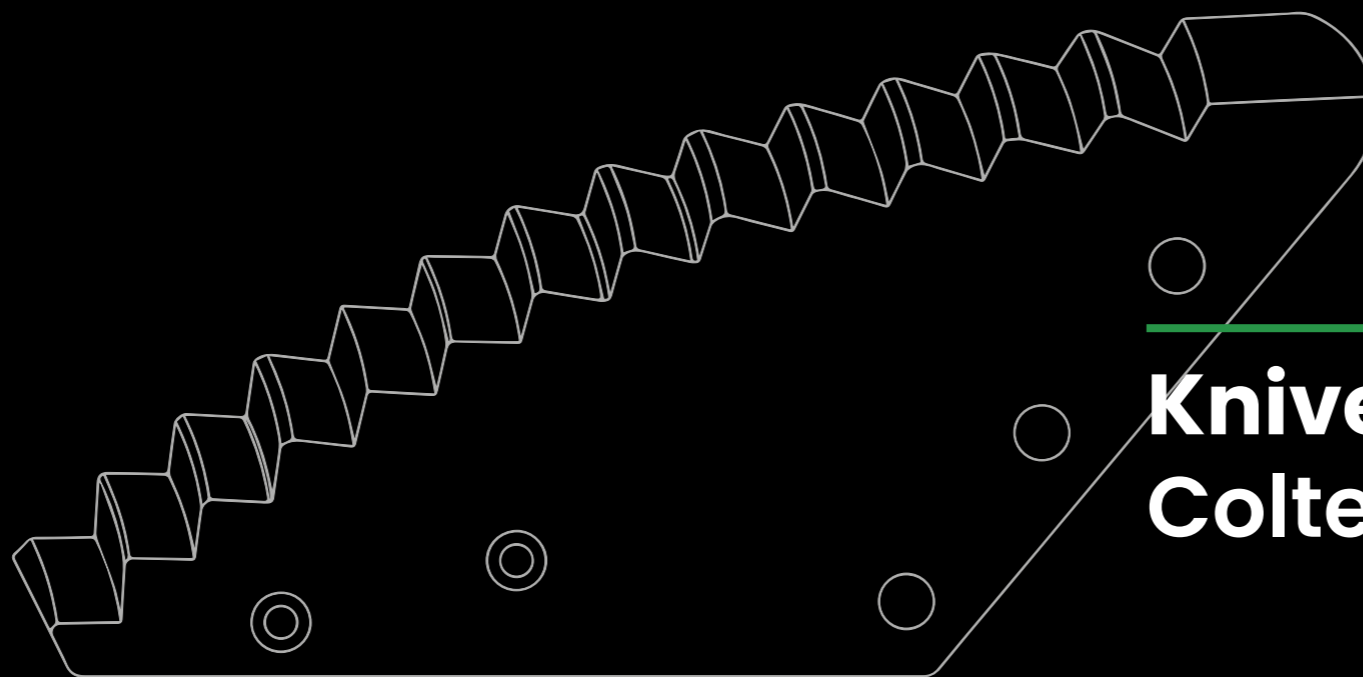

Knives for feed mixers
Coltelli per carri miscelatori

ART. 210 MB 13

Right Knife
Hole dimension \varnothing 22,5 mm
Thickness 3,5 mm
Weight 0,10 kg

Coltello Destro
Dimensione foro \varnothing 22,5 mm
Spessore 3,5 mm
Peso 0,10 kg

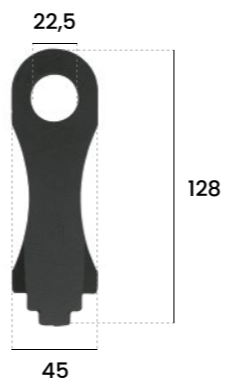

ART. 255 MC 13

Right Knife
Hole dimension \varnothing 22,5 mm
Thickness 3,5 mm
Weight 0,10 kg

Coltello Destro
Dimensione foro \varnothing 22,5 mm
Spessore 3,5 mm
Peso 0,10 kg



ART. 200 RLT 95

Sleek Round Knife
Flare hole dimension \varnothing 10,5 mm
Thickness 5,0 mm
Weight 0,25 kg

Coltello Tondo Liscio
Dimensione foro svasato \varnothing 10,5 mm
Spessore 5,0 mm
Peso 0,25 kg



ART. 200 RL 95

Sleek Round Knife
Square hole dimension 11x11 mm
Thickness 5,0 mm
Weight 0,25 kg

Coltello Tondo Liscio
Dimensione foro quadrato 11x11 mm
Spessore 5,0 mm
Peso 0,25 kg



ART. 200 RD 95

Toothed Knife
Square hole dimension 11x11 mm
Thickness 5,0 mm
Weight 0,19 kg

Coltello Dentato
Dimensione foro quadrato 11x11 mm
Spessore 5,0 mm
Peso 0,19 kg



ART. 200 SF 90182

Toothed Knife
Thickness 5,0 mm
Weight 0,24 kg.
Holes dimension: 12x18 mm

Coltello Dentato
Spessore 5,0 mm
Peso 0,24 kg
Dimensione fori: 12x18 mm

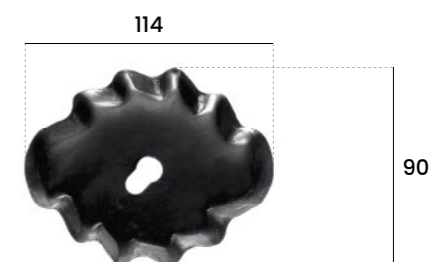

ART. 200 RQ 85

Square Sleek Knife
Square hole dimension 11x11 mm
Thickness 5,0 mm
Weight 0,22 kg.

Coltello Quadro Liscio
Dimensione foro quadrato 11x11 mm
Spessore 5,0 mm
Peso 0,22 kg

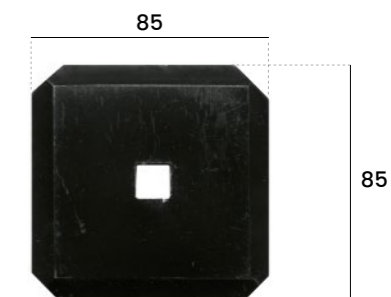

ART. 200 RQ 100

Square Sleek Knife
Square hole dimension 11x11 mm
Thickness 5,0 mm
Weight 0,32 kg.

Coltello Quadro Liscio
Dimensione foro quadrato 11x11 mm
Spessore 5,0 mm
Peso 0,32 kg

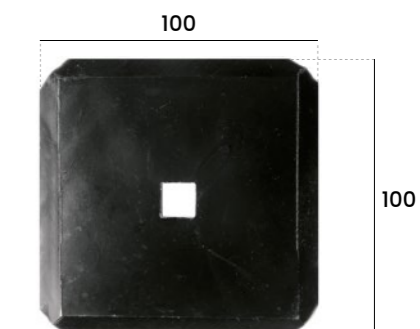

ART. 200 RQ 85/12

Square Sleek Knife
Round hole dimension \varnothing 12,5 mm
Thickness 5,0 mm
Weight 0,22 kg.

Coltello Quadro Liscio
Dimensione foro tondo \varnothing 12,5 mm
Spessore 5,0 mm
Peso 0,22 kg

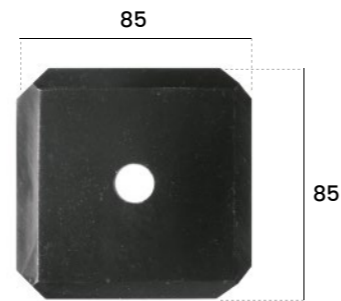

ART. 200 RQ 100/12

Square Sleek Knife
Round hole dimension \varnothing 12,5 mm
Thickness 5,0 mm
Weight 0,32 kg.

Coltello Quadro Liscio
Dimensione foro rotondo \varnothing 12,5 mm
Spessore 5,0 mm
Peso 0,32 kg

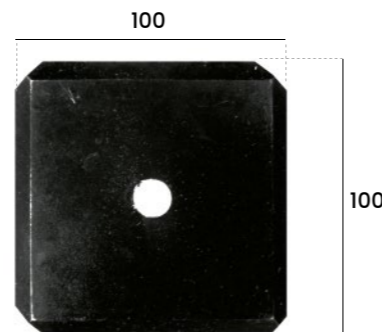

ART. 200 T 182 90 DX - ART. 200 T 182 90 SX

Toothed Knife
Holes dimension:
Hole no. 1: 12x24 mm
Hole no. 2: 12x29 mm
Type : right/left
Thickness 5,0 mm
Weight 0,48 kg.

Coltello Dentato
Dimensione fori:
Foro n.1: 12x24 mm
Foro n.2: 12x 29 mm
Tipo: destro/sinistro
Spessore 5,0 mm
Peso 0,48 kg

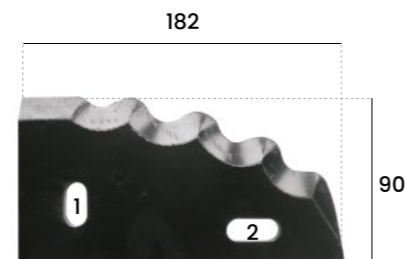

ART. 200 T 190 90 DX - ART. 200 T 190 90 SX

Toothed Knife
Holes dimension:
Hole no. 1: 11x24 mm
Hole no. 2: 11x29 mm
Type : right/left
Thickness 5,0 mm
Weight 0,50 kg.

Coltello Dentato
Dimensione fori:
Foro n.1: 11x24 mm
Foro n.2: 11x 29 mm
Tipo: destro/sinistro
Spessore 5,0 mm
Peso 0,50 kg

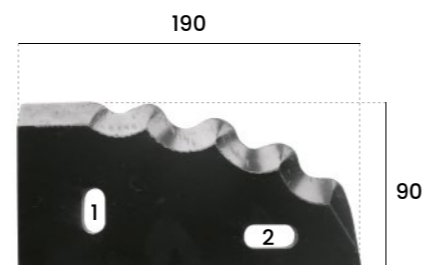

ART. 200 R 190/70

Toothed Knife
Square holes dimension 11x11 mm
Thickness 5,0 mm
Weight 0,38 kg.

Coltello Dentato
Dimensione fori quadrati 11x11 mm
Spessore 5,0 mm
Peso 0,38 kg

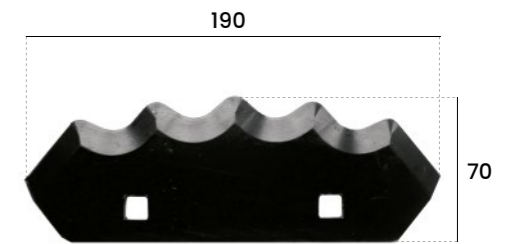

ART. 200 MLF 28

Semicircular Sleek Knife
Square holes dimension 11x11 mm
Thickness 5,0/6,0 mm
Weight 0,80 kg.

Coltello Semicircolare Liscio
Dimensione fori quadrati 11x11 mm
Spessore 5,0/6,0 mm
Peso 0,80 kg

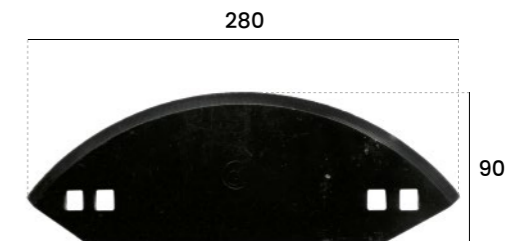

ART. 200 ML 28

Semicircular Sleek Knife
Square holes dimension 11x11 mm
Thickness 5,0/6,0 mm
Weight 0,93 kg.

Coltello Semicircolare Liscio
Dimensione fori quadrati 11x11 mm
Spessore 5,0/6,0 mm
Peso 0,93 kg

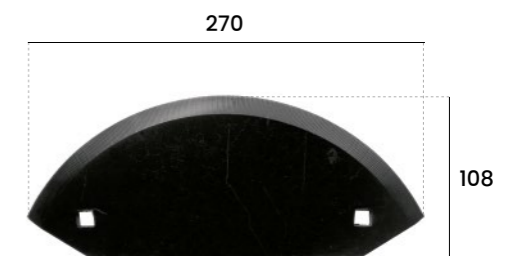

ART. 200 ML 30

Semicircular Sleek Knife
Thickness 5,0/6,0 mm
Weight 0,93 kg
2 x Square holes dimension 11x11 mm
2 x holes dimension 12 > 18 mm

Coltello Semicircolare Liscio
Spessore 5,0/6,0 mm
Peso 0,93 kg
2 x fori quadrati dimensione 11x11 mm
2 x fori dimensione 12 > 18 mm

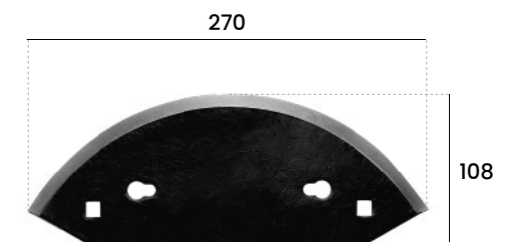

ART. 200 R 142/102 DX – ART. 200 R 142/102 SX

Toothed Knife
Type: left/right
Square holes dimension 11x11 mm
Thickness 5,0 mm
Weight 0,34 kg.

Coltello Dentato
Tipo: sinistra/destra
Dimensione fori quadrati 11x11 mm
Spessore 5,0 mm
Peso 0,34 kg

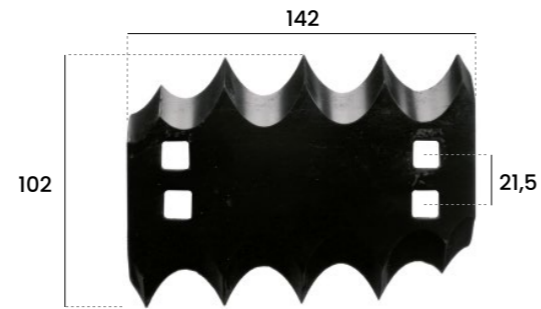

ART. 200 RQ 159 947 DX – ART. 200 RQ 159 947 SX

Toothed Knife Type: left/right
Square holes dimension 12x12 mm
Thickness 5,0 mm
Weight 0,38 kg.

Coltello Dentato
Tipo: sinistra/destra
Dimensione fori quadrati 12x12 mm
Spessore 5,0 mm
Peso 0,38 kg

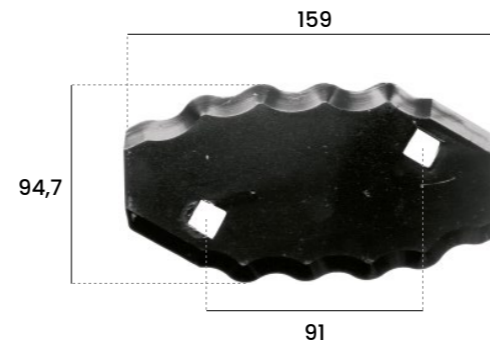

ART. 200 R 159 94 DX – ART. 200 R 159 94 SX

Toothed Knife
Type: left/right
Square holes dimension $\varnothing 12 \times 8$ mm
Thickness 5,0 mm
Weight 0,38 kg

Coltello Dentato
Tipo: sinistra/destra
Dimensione fori $\varnothing 12 \times 8$ mm
Spessore 5,0 mm
Peso 0,38 kg

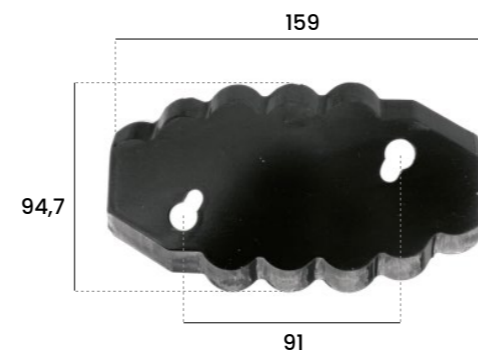

ART. 200 RDS 95

Toothed knife
Square hole dimension 11x11 mm
Thickness 5,0 mm
Weight 0,18 kg.

Coltello Dentato
Dimensione foro quadrato 11x11 mm
Spessore 5,0 mm
Peso 0,18 kg

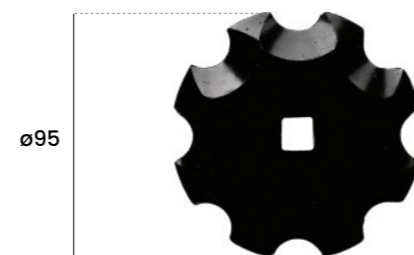

ART. 200 R 205 55

Semicircular Sleek Knife
Square holes dimension 12x12 mm
Thickness 5,0 mm
Weight 0,32 kg.

Coltello Semicircolare Liscio
Dimensione fori quadrati 12x12 mm
Spessore 5,0 mm
Peso 0,32 kg

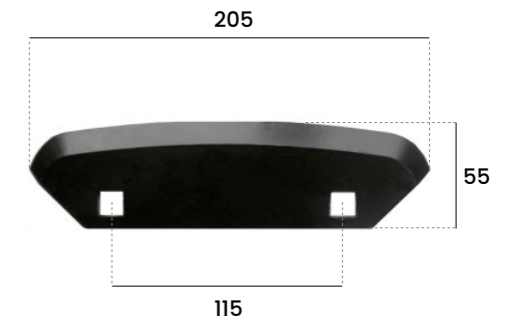

ART. 200 RO 205 55

Semicircular Sleek Knife
Teardrop shaped hole dimension $\varnothing 12 \times 8$ mm
Thickness 5,0 mm
Weight 0,32 kg.

Coltello Semicircolare Liscio
Dimensione foro a goccia $\varnothing 12 \times 8$ mm
Spessore 5,0 mm
Peso 0,32 kg

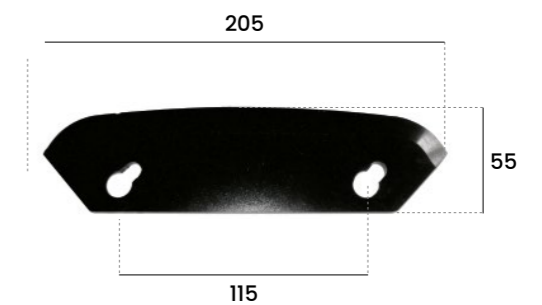

ART. 200 RD 110

Toothed Knife
Square hole dimension 11x11 mm
Thickness 5,0/6,0 mm
Weight 0,32 kg.

Coltello Dentato
Dimensione foro quadrato 11x11 mm
Spessore 5,0/6,0 mm
Peso 0,32 kg



ART. 200 T 86/31

Sleek Knives
Square hole dimension 11x11 mm
Thickness 5,0 mm
Weight 0,51 kg.

Coltello Liscio
Dimensione foro quadrato 11x11 mm
Spessore 5,0 mm
Peso 0,51 kg

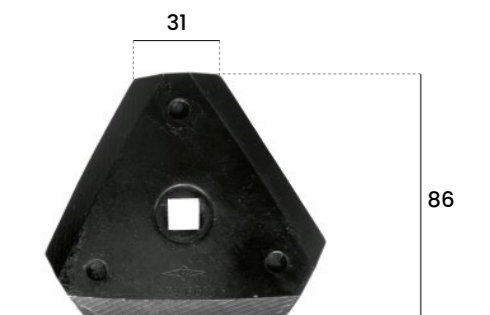

ART. 200 G 190/94

Toothed Knife
thickness 5,00 mm
Weight 0,50 kg.

Coltello Dentato
Spessore 5,0 mm
Peso 0,50 kg

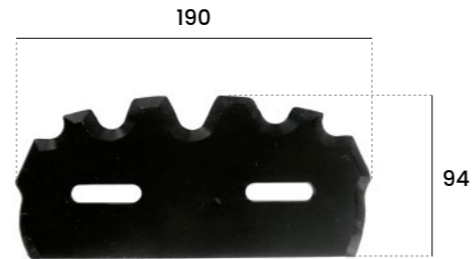

ART. 200 T 212 90 DX – ART. 200 T 212 90 SX

Toothed Knife, 2 or 3 holes
Hole dimension 18x13 mm
Type: right/left
Thickness 5,0 mm
Weight 0,43 kg

Coltello Dentato
Dimensione foro 18x13 mm
Tipo: destra/sinistra
Spessore 5,0 mm
Peso 0,43 kg

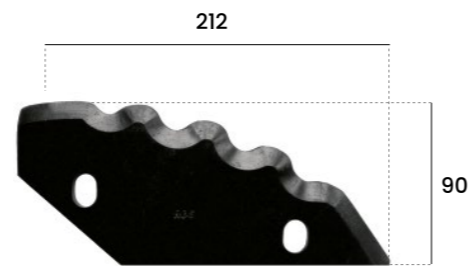

ART. 200 T 160 80 DX – ART. 200 T 160 80 SX

Toothed Knife
Hole dimension 19x12 mm
Type: right/left
Thickness 5,0 mm
Weight 0,38 kg

Coltello Dentato
Dimensione foro 19x12 mm
Tipo: destra/sinistra
Spessore 5,0 mm
Peso 0,43 kg

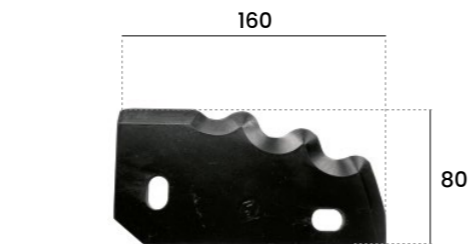

ART. 205 K 254 80

Toothed Knife
2x square holes 20x13 mm
Thickness 6,0 mm
Weight 0,50 kg

Coltello Dentato
2x fori quadrati 20x13 mm
Spessore 6,0 mm
Peso 0,50 kg

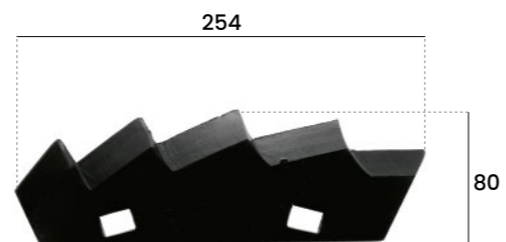

ART. 205 K 240 74

Toothed Knife
2x square holes 20x13 mm
Thickness 6,0 mm
Weight 0,55 kg.

Coltello Dentato
2x fori quadrati 20x13 mm
Spessore 6,0 mm
Peso 0,5 kg

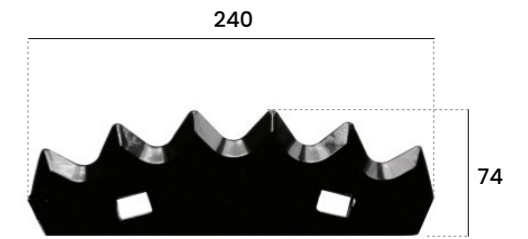

ART. 210 CV 10

Toothed Knife for Vertical System
3x holes Ø 20,5 mm
2x holes Ø 12 mm
Thickness 6,0 mm
Weight 3,25 kg.

Coltello Dentato per Dispositivo Verticale
3x fori Ø 20,5 mm
2x fori Ø 12 mm
Spessore 6,0 mm
Peso 3,25 kg

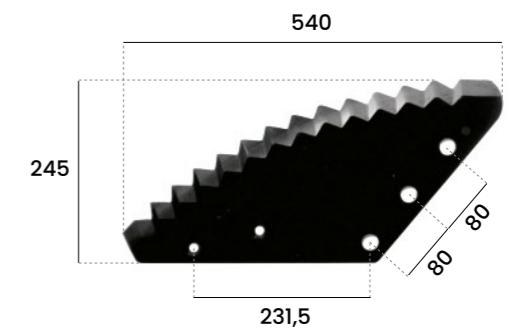

ART. 200 CVS 11

Toothed Knife for Vertical System
Thickness 6,0 mm
Weight 3,25 kg

Coltello Dentato per Dispositivo Verticale
Spessore 6,0 mm
Peso 3,25 kg

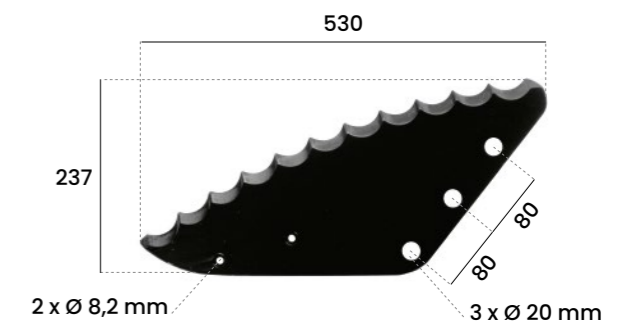

ART. 200 CVS 15

Toothed Knife for Vertical System
Thickness 6,0 mm
Weight 3,25 kg

Coltello Dentato per Dispositivo Verticale
Spessore 6,0 mm
Peso 3,25 kg

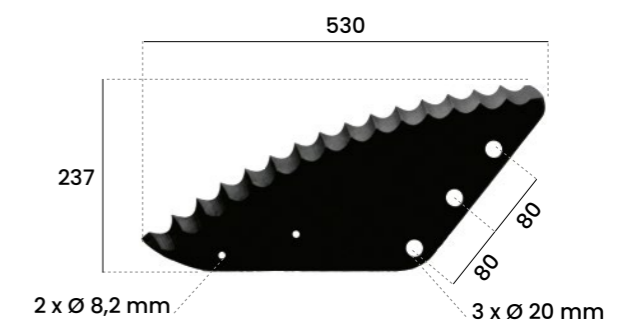

ART. 210 CV 15

Toothed Knife for Vertical System
3x holes Ø 19,5 mm
Thickness 6,0 mm
Weight 3,25 kg

Coltello Dentato per Dispositivo Verticale
3x fori Ø 19,5 mm
Spessore 6,0 mm
Peso 3,25 kg

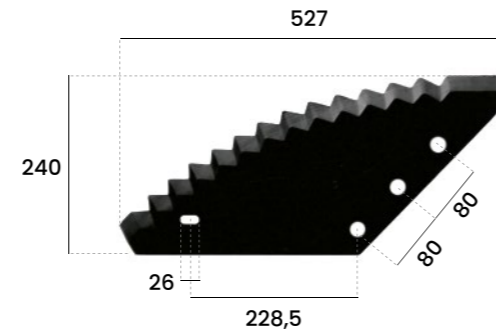

ART. 200 CVK 80

Toothed Knife for Vertical System
Thickness 8,0 mm
Weight 4,20 kg

Coltello Dentato per Dispositivo Verticale
Spessore 8,0 mm
Peso 4,20 kg

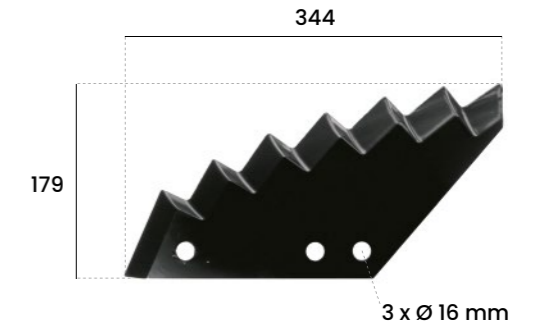

ART. 210 CV 25

Toothed Knife for Vertical System
3x holes Ø 18,5 mm
Thickness 5,0/6,0 mm
Weight 2,60 kg

Coltello Dentato per Dispositivo Verticale
3x fori Ø 18,5 mm
Spessore 5,0/6,0 mm
Peso 2,60 kg

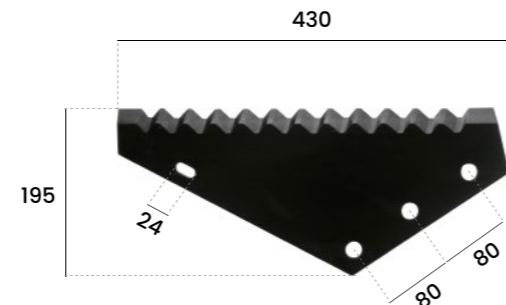

ART. 210 CVF 10 DX - ART. 210 CVF 10 SX

Toothed Knife for Vertical System
Thickness 6,0 mm
Weight 3,25 kg
3x square holes 19x19 mm
3x holes Ø 12 mm

Coltello Dentato per Dispositivo Verticale
Spessore 6,0 mm
Peso 3,25 kg
3x fori quadrati 19x19 mm
3x fori Ø 12 mm

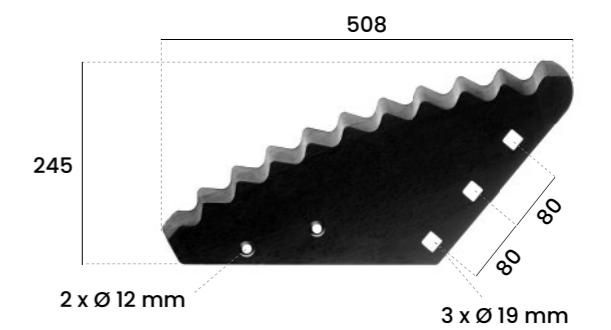

ART. 210 CV 50 DX - ART. 210 CV 51 SX

Toothed Knife for Vertical System
Thickness 6,0 mm
Weight 3,25 kg

Coltello Dentato per Dispositivo Verticale
Spessore 6,0 mm
Peso 3,25 kg

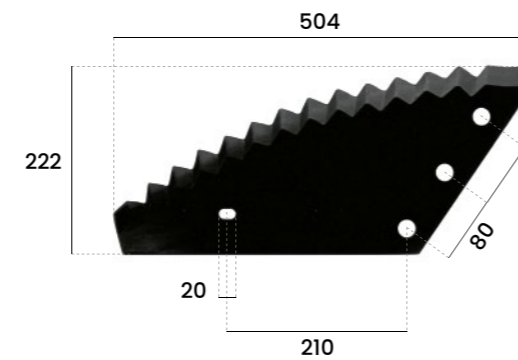

ART. 210 CVM 057

Toothed Knife for Vertical System
Thickness 6,0 mm
Weight 2,90 kg

Coltello Dentato per Dispositivo Verticale
Spessore 6,0 mm
Peso 2,90 kg

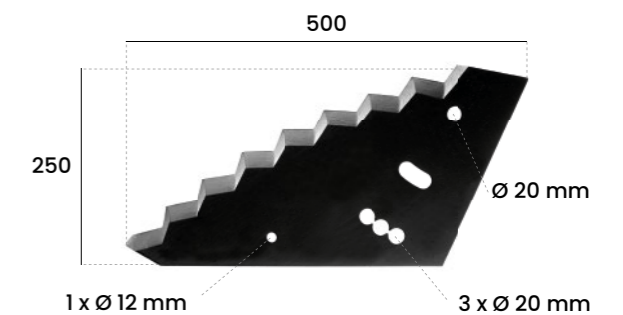

ART. 210 CV 70

Toothed Knife for Vertical System
Thickness 6,0 mm
Weight 3,25 kg

Coltello Dentato per Dispositivo Verticale
Spessore 6,0 mm
Peso 3,25 kg

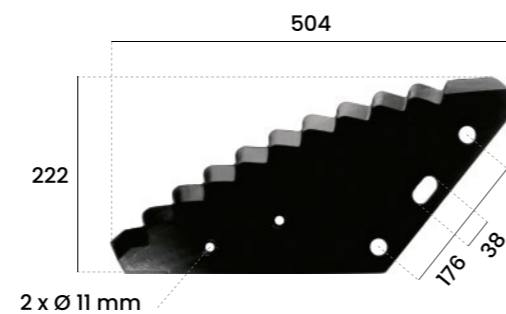

ART. 210 CV 95

Toothed Knife for Vertical System
Thickness 6,0 mm
Weight 2,90 kg

Coltello Dentato per Dispositivo Verticale
Spessore 6,0 mm
Peso 2,90 kg

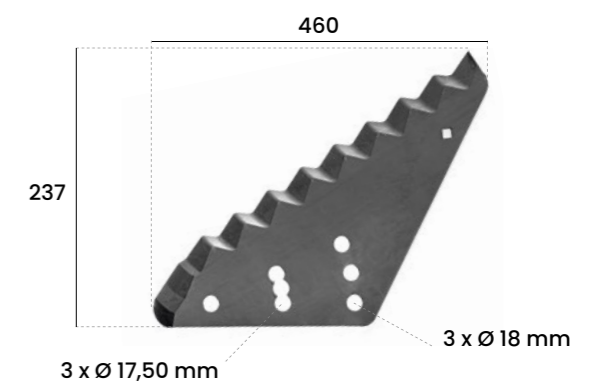

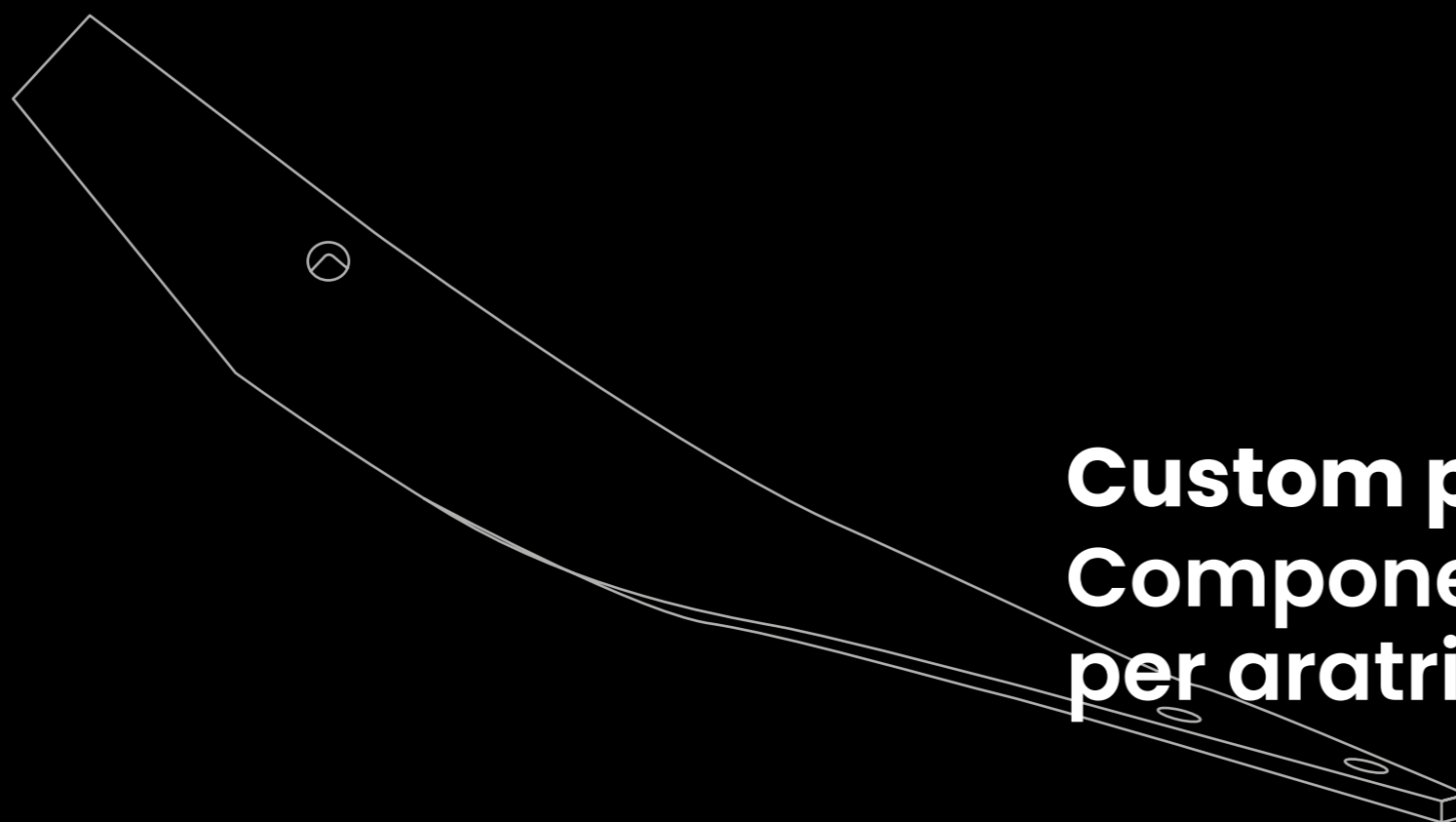

Custom ploughs parts
Componenti personalizzati
per aratri



CUSTOM PLOUGHS PARTS COMPONENTI PERSONALIZZATI PER ARATRI

Grazie allo studio e alla conoscenza della materia prima e della sua lavorazione, nel rispetto della tradizione produttiva, O.F.A.S. rende possibile la creazione di pezzi su misura per aratri per soddisfare le richieste del cliente.

Thanks to the study and the knowledge of the raw material and its processing, respecting the production tradition, O.F.A.S. makes it possible to create tailor-made ploughs parts to meet customer requirements.

INDICAZIONI PER LA LETTURA DELLE TABELLE INDICATIONS FOR READING THE TABLES

Traduzioni termini contenuti all'interno delle tabelle del catalogo
Translations of terms contained within the catalogue tables

EN	ITA
Anchor Wing	Ala dell'Ancora
Article Description	Descrizione Articolo
Central Mouldboard	Versoio Centrale
Central Anchor Mouldboard	Versoio d'Ancoraggio Centrale
Central Point	Punta Centrale
Description	Descrizione
Diameter	Diametro
Dimension	Dimensione
Double Blade	Lama Doppia
Flare Hole	Foro Svasato
Front	Anteriore
Helper S. Tine	Rinforzo Molla
Hole Cod.	Codice Foro
Hole Dimension	Dimensione Foro
Holes	Fori
Left	Sinistra
Machine Frame	Telaio Macchina
Matched Hub	Hub Abbinato
Matched S. Tine	Molla Abbinata
Mould Cod.	Codice Stampo
Notched Disc	Disco Dentato
Number of Notches	Numero di Denti
Plain Disc	Disco Liscio
Rear	Posteriore
Right	Destra
Round Hole	Foro Tondo
Section	Sezione
Single Blade	Lama Singola
Square Hole	Foro Quadrato
Thickness	Spessore
Type	Tipo
Type Anchor	Tipo Ancora
Type High Anchor	Tipo Ancora Alta
Weight	Peso
With reversible point	Con vomere reversibile
Without reversible point	Senza vomere reversibile

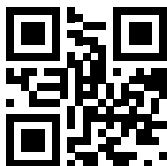

O.F.A.S.
Via Dante Alighieri, 25
36065 Mussolente (VI) - Italy

+39 0424 577 222
info@ofas.it

www.ofas.it

007



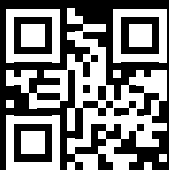

O.F.A.S.
Via Dante Alighieri, 25
36065 Mussolente (VI) - Italy

+39 0424 577 222
info@ofas.it

www.ofas.it